



# Complete care

Reducing healthcare associated infections by offering the best innovative infection prevention products together with market leading after sales support.

"GAMA Healthcare has provided an excellent service and their organisation-wide training programme is especially commendable."

Clinical Lead Infection Prevention and Control,  
Nottingham University Hospitals.

# CONTENTS

<b>Introduction</b>	<b>4</b>	<b>Barrier protection</b>	<b>36</b>
<b>Infection prevention</b>	<b>5</b>	Rediroom	37
The benefits of Clinell	6	Trolley Protector	39
The importance of good cleaning	7	<b>EasyClean equipment</b>	<b>40</b>
<b>Surface care</b>	<b>13</b>	Computer Accessories	41
<b>Everyday surface care</b>	<b>13</b>	Washable Keyboards	42
Universal Range	14	Washable Mice	42
Alcohol Wipes	15	EasyClean Commode	43
2% Chlorhexidine in 70% Alcohol Wipes	16	<b>Support products</b>	<b>44</b>
Detergent Range	17	Indicator Products	45
<b>High level disinfection</b>	<b>18</b>	<b>Implementation &amp; training</b>	<b>47</b>
Sporicidal Wipes	20	Training Package	48
Sporicidal Granules	21	EvaluClean	49
Drain Disinfectant	22	Commode Audit App	50
Spill Wipes	23	AskMe Survey App	51
<b>Skin care</b>	<b>24</b>	<b>References</b>	<b>52</b>
Antimicrobial Hand Wipes	25		
Hand Sanitising Gels	26		
2% Chlorhexidine in 70% Alcohol Skin	27		
HEXI CATH	28		
<b>Patient bathing products</b>	<b>29</b>		
Chlorhexidine Bathing Range	31		
Bed Bathing Range	32		
Personal Care Wipes	33		
Barrier Cloths	34		

# INTRODUCTION

GAMA Healthcare is at the forefront of infection prevention and control technology. Our products are trusted by the NHS to be effective and easy to use, which is why GAMA Healthcare is the leading wipe supplier in the UK. We apply this expertise to over 60 countries worldwide.

---

## Why choose GAMA Healthcare?

Hospitals are under even greater pressure to further reduce healthcare-associated infection (HCAI) rates than at any time previous, and are having to do so under greater public scrutiny and tighter budgets.

Choosing the right products and the right company is vital for hospitals as they strive to reach these goals. You can trust GAMA Healthcare to provide high-quality, innovative products and an after-sales service that is simply world class.

GAMA Healthcare believes in working with you to help reduce HCAI rates and achieve your targets to protect public health. We work closely with experienced IPC professionals to develop and provide the best products, training, brochures and on-site resources available.

A study group of over 20 senior IPC professionals worked with us to help create our revolutionary, tablet-based Training Package. Our comprehensive, interactive Training Package is an integral part of the training we offer to all nursing and housekeeping staff – alongside our specialist IPC Nurse Trainers.





The premium  
choice for IPC  
professionals.

## Infection prevention

The Clinell product range combines innovative technology with ease of use, providing healthcare professionals with the most effective solutions available.

Clinell's product claims are supported and verified by the strongest data package within the market. Clinell is the most trusted wipe brand in the UK, offering market-leading aftercare support and comprehensive training.

# THE BENEFITS OF CLINELL

Clinell disinfectant wet wipes consistently deliver a stable and effective dose of disinfectant that has been tested and proven to kill microorganisms within realistic contact times and conditions – unlike solutions, sprays and dry wipes.

---

## Hoffman checklist

It can be difficult and time consuming to evaluate which of the many formulas and systems are effective and which will work best for your Trust.

Dr. Peter Hoffman (Consultant Clinical Scientist, Antimicrobial Resistance and Healthcare Infections Reference Unit, Public Health England) in his presentation 'Wipe it out: The evidence for selection & use of disinfectant wipes' recommended the below checklist which IPCNs could use to help evaluate potential IPC manufacturers:

### 1. Effective formula

It is important that the IPC company adequately explains how the formula works, explain what the active compounds are and outline their relationship with common bacteria. How the formula reacts with different wipe fibre compositions is of equal importance, especially when discussing solutions and sprays.

**“Sometimes the fabric of the wipe can inactivate the disinfectant.”**

### 2. Relevant testing

It is vital that the claims made and results advertised are from tests on liquid expressed from the wipe and not on solutions to be applied to wipes.

**“Suspension tests simulate specific use situations (none of which are similar to wipe conditions).”**

### 3. Realistic contact times

**“A disinfectant test is a single, repeatable, highly controlled situation. Real life is not.”**

All data should be readily available and relevant. European standardised tests are often performed in unrealistic time periods and conditions. The data should reflect achievable contact times and conditions, not just headline method and results.

**“Tests can be done either in ‘clean’ or ‘dirty’ conditions. ‘Clean’ is easier to pass. ‘Dirty’ is more difficult but may simulate user conditions, such as commodes, better.”**

### 4. Scientifically validated

It is important that the manufacturer has an experienced and reputable microbiologist who is available to explain the importance of all aspects of the formula and relevant testing from culture preparation to neutraliser validation.

### 5. Training

Comprehensive training on the correct use and best practice for products should be made available.

### 6. Published user studies

Reputable IPC companies should be able to undertake and publish practical user results for their products (phase 3 testing).

### 7. Complies with regulations

All products should comply to current product safety regulations and occupational health considerations and guidelines.

GAMA Healthcare is confident that it conforms to all these requirements and will continue to maintain full transparency on all testing and formula characteristics.

# THE IMPORTANCE OF GOOD CLEANING

In England's acute hospitals, 1 in every 16 patients will have a Healthcare Associated Infection (HCAI)<sup>1</sup>. Infected patients shed harmful microorganisms into the environment, which can be transferred to patients, visitors and staff.

## Why should we clean?

Every year, over 4 million people in Europe acquire a Healthcare Associated Infection – with 37,000 dying as a direct result<sup>2</sup>. For patients, HCAIs are dangerous, life-altering and potentially fatal. For hospitals, HCAIs put limited resources under phenomenal strain.

**Enhanced cleaning practices are reported to save hospitals between £30,000–£70,000 per annum<sup>3</sup>.**

A number of investigators have highlighted the importance of environmental contamination in the transmission of clinically relevant pathogens such as *C. difficile* and MRSA<sup>4-8</sup>. That is why surface disinfection is now a corner stone of international infection prevention policies.

The most common source of microorganisms in a hospital setting are the patients themselves; infected and colonised patients (and hospital staff) shed bacteria, viruses and spores into the hospital environment. Studies have shown that, after seven days in a hospital, 62% of all patients were positive for enterococcal hand contamination<sup>9</sup> and 39% of patients have at least one hospital-associated pathogen on their hands within 48 hours of admission<sup>10</sup>.

In the hospital environment, areas near the patient and high-touch surfaces have been found to harbour microorganisms, increasing the risk of infection<sup>4,8,11-13</sup>.

Adequate cleaning and/or disinfection of these surfaces (bedrails, commodes, door handles, light switches, patient call button, surfaces and equipment in close proximity to the patient) have been shown to be of particular importance<sup>13-15</sup>. Hand hygiene before and after touching these surfaces is often inadequate<sup>16</sup>.

Many organisms responsible for HCAIs including MRSA, *C. difficile*, norovirus and vancomycin-resistant enterococci, survive and persist on hospital surfaces at concentrations sufficient for transmission and transference to the hands of healthcare workers<sup>17</sup>.

**The inherent structure of a *C. difficile* spore allows it to resist environmental stresses such as drying and disinfection, allowing it to persist on surfaces for more than five months<sup>17,18</sup>.**

There now exists an increasing body of knowledge which highlights that improved infection prevention practices can help break the chain of transmission<sup>19</sup>. A review of the epidemiological and microbiological data regarding surface disinfection was undertaken by Rutala and Weber,<sup>11</sup> with the authors recommending routine cleaning and disinfection of surfaces.

**Contaminated hospital surfaces and environments play a key role in the transmission of *C. difficile*. Enhanced environmental cleaning with sporicidal agents of rooms housing *C. difficile*-infected patients is warranted<sup>11</sup>.**

Studies have shown that when cleaning is sub-optimal, it can place patients, staff and visitors at risk<sup>20</sup>. A valid infection prevention intervention will reduce the microbial burden in the environment and hence the persistence of the organism, which can only be achieved with appropriate cleaning and disinfection programmes<sup>3,8</sup>.

**Improved cleaning and disinfection of room surfaces decreases the risk of healthcare-associated infections<sup>11</sup>.**



# THE IMPORTANCE OF GOOD CLEANING

The molecular structure of the dry wipe can bind active components of the disinfectant – preventing their release to the surface<sup>21</sup>.

## Solutions, sprays and dry wipes are ineffective

### DRY WIPES CAN INTERFERE WITH THE ACTION OF COMMON HOSPITAL DISINFECTANTS<sup>21</sup>.

It is difficult to achieve consistent disinfectant coverage with sprays. It is even more difficult to activate consistent disinfectant coverage with dual-chamber sprays.

Solutions are often mixed inconsistently and many disinfectants can be less effective when you dip soiled cloths into the solution.

The efficacy testing on disinfectant sprays and solutions have been performed on the liquid. However, dry wipes are made of either synthetic or natural materials which can bind to the biocide, changing the concentration of the active disinfectant that is released.

This means that the liquid coming off the dry wipe may not be the same as the liquid that went into it. For example, it has been shown that the use of quaternary ammonium compounds (QACs) with an inappropriate type of fabric will effectively abolish its antimicrobial activity<sup>22</sup>.

It is common to use sprays at an angle, to shoot down onto the surface. When using dual-chamber sprays at an angle, more solution will enter the head from one chamber than the other. This creates an inadequate mix that can lead to a suboptimal concentration of biocides.

In a laboratory setting the biocide may not be tested from a dual-chamber spray bottle, hence the test data may not reflect practical, in-use, conditions.

In addition to affecting the efficacy of the biocide, inconsistent mixing increases wastage – reducing the number of uses and resulting in increased cost.

The final mixed solution of some two-part sprays is gel based. This gel can build up over time, clogging the nozzle and inhibiting the spray. Blocked nozzles lead to even greater inconsistency of coverage than usual.

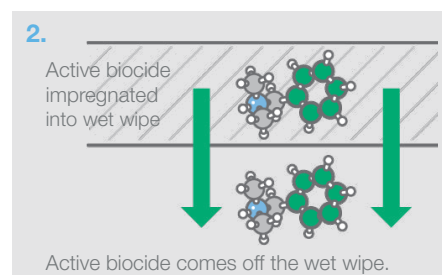
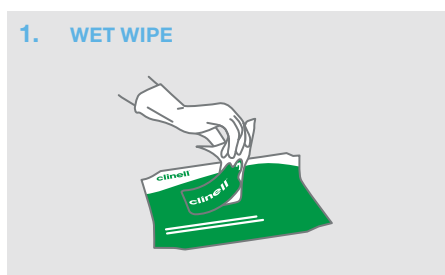
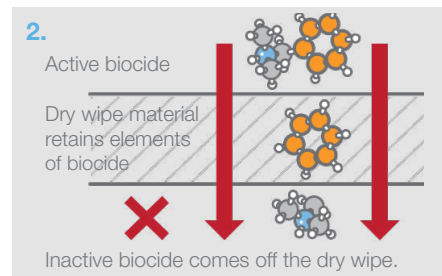

There is evidence that chronic inhalation of chlorine can increase the risk of lung fibrosis<sup>23</sup>.



### Dual-chamber sprays and wipes

<p><b>1.</b> Spray does not mix effectively</p> <p>More solution from one chamber enters the spray head</p> <p>When used at an angle, different quantities of solutions mix, producing an ineffective disinfectant.</p>	<p><b>2.</b></p> <p>Wasted solution</p> <p>Inconsistent mixing wastes solution, reducing number of uses and increasing costs.</p>	<p><b>3.</b> Wasted solution</p> <p>Inconsistent biocide coverage</p> <p>Blocked nozzles reduce the biocidal coverage of the spray.</p>
<p><b>4.</b></p> <p>Low biocide concentration may select for resistance.</p>	<p><b>5.</b></p> <p>Inconsistent biocide coverage is ineffective.</p>	<p><b>6.</b></p> <p>In contrast, a wet wipe provides a uniform concentration of biocide.</p>

### Health Issues

<p><b>1.</b></p> <p>Toxic fumes from chlorine based products.</p>	<p><b>2.</b></p> <p>Lung damage.</p>
<p><b>3.</b></p> <p>Eye irritation.</p>	<p><b>4.</b></p> <p>Nose and throat damage, causing coughs and shortness of breath.</p>

#### **TOXIC FUMES FROM CHLORINE CAN AFFECT THE LUNGS, EYES, NOSE AND THROAT.**

All disinfecting procedures must include a risk assessment of potential toxicological hazards. Chlorine is hazardous to both user and patients, emitting toxic fumes and by-products. Chlorine inhalation has been shown to cause obstructive lung disease, eye irritation, nasal complaints, cough and skin complaints<sup>23</sup>.

# THE IMPORTANCE OF GOOD CLEANING

93% of all reusable cloths, tested after laundry, were found to still have viable microorganisms<sup>24</sup>.



## Issues with reusable cloths

**OVER TIME, DAMP CLOTHS BREED MICROORGANISMS. THESE ARE THEN TRANSFERRED ONTO SURFACES WHEN CLOTHS ARE RE-USED.**

When using the same cloth throughout the day it usually remains damp in between uses and therefore drying out of the cloth is often incomplete. This leaves small areas of dampness within the cloth which can lead to growth of mould and bacteria. These microorganisms can then be spread around surfaces when the cloth is re-used.

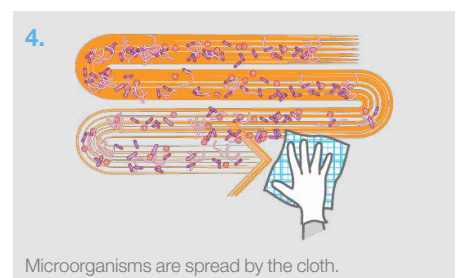
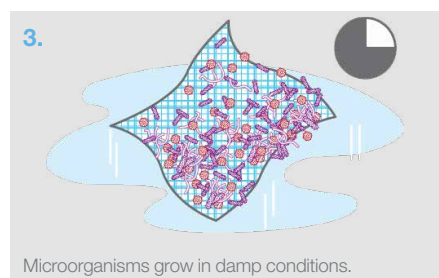
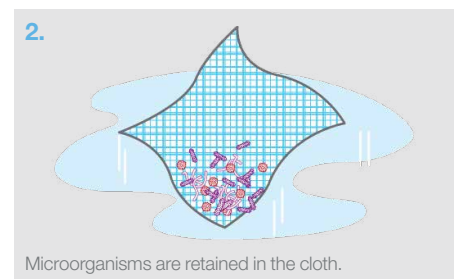

Clinell wet wipes consistently deliver a stable, effective dose of disinfectant, which has been tested and proven to kill microorganisms within realistic contact times and conditions, unlike solutions, sprays and reusable cloths.

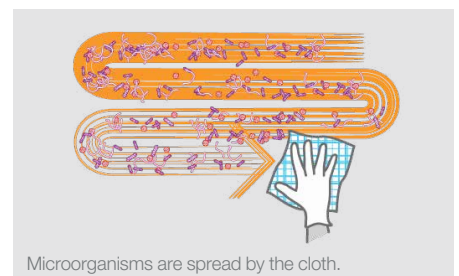

Hospital laundering practices are not only insufficient at removing microorganisms but may also even add contaminants to reusable cleaning cloths<sup>25</sup>.

Over dilution creates an ineffective, weak solution. Under dilution creates a strong solution that may damage equipment. Dirt within the solution and on the surface makes chlorine ineffective.

### Dilution errors with liquids, powders and tablets

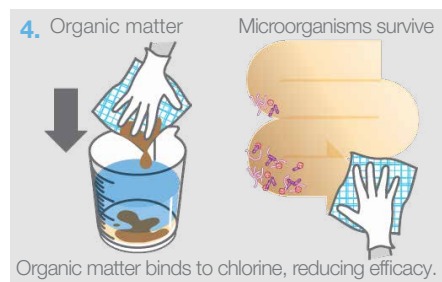
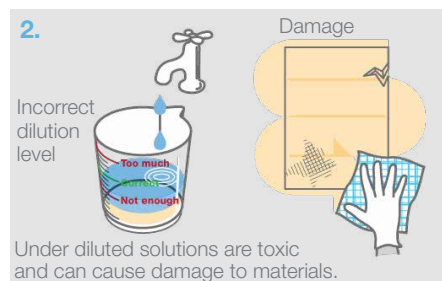
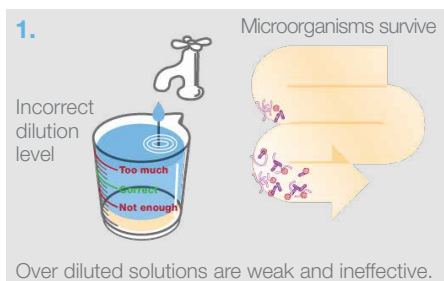

There is always a risk of user error when making up a chlorine solution every day.

Dilution errors can easily occur when preparing disinfectant solutions. An error in using too much water when mixing up a solution can result in a disinfectant that is too weak and ineffective. Conversely, using too little water results in a solution that is too strong, toxic and harmful to both surfaces and the user.

Chlorine is ineffective in dirty conditions; dirty surfaces will need to be pre-cleaned<sup>26</sup>. Clinell Universal and Sporidical Wipes contain detergent and biocides, which clean and disinfect in one step.

Chlorine breaks down over time and, since it is common practice to leave the mixed up solution for many hours whilst using it, this often results in an ineffective solution. When a cloth is dipped back into the bucket, organic matter is introduced – accelerating the breakdown of chlorine.

These issues can all lead to a significant variation in the concentration of chlorine. With a wet wipe you get a standard, consistent concentration that is always correct – no matter how and when it is used.

Different cloth materials can affect detergent and disinfectant solutions in different ways. You can never be sure (unless tested) that the solution coming off the cloth is the same as the solution that went into it<sup>21</sup>.

The adsorption of chlorine-based products by cloths has been clearly demonstrated<sup>27</sup>. This means that the concentration of solution released from the cloths may be much lower than the solution tested in the laboratory.

**At GAMA Healthcare we always test the liquid released from the wipe so that there is 100% certainty that the solution on the surface works effectively.**



# THE IMPORTANCE OF GOOD CLEANING

Good cleaning practices reduce microorganisms in the environment, which can lead to a reduction in incidence of HCAs, protecting patients, staff and reducing hospital spending.

## How to clean

### THE MOST EFFECTIVE WAY TO KEEP A SURFACE CLEAN IS TO FOLLOW THESE STEPS:

1. Wash and dry hands.
2. Perform a risk assessment and choose the appropriate Personal Protective Equipment (PPE).
3. Select the correct wipe for the task. Only take one wipe.
4. Remove any heavy soiling as this can reduce the effectiveness of disinfectant wipes.
5. Wipe all surfaces including the underneath, paying special attention to 'high touch' points.
6. Wipe from top to bottom, going from clean to dirty in an 'S' shaped motion.
7. Dispose of wipe between each separate surface or if it becomes dry or soiled.
8. Remove any PPE then wash and dry hands.
9. Apply indicator tape/note if this is local policy.

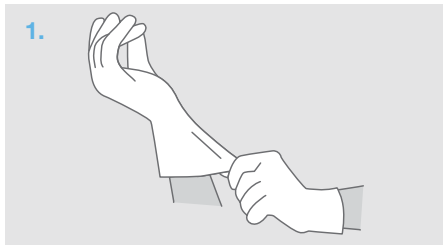

Do a risk assessment, wear recommended PPE. Take one wipe from the pack.

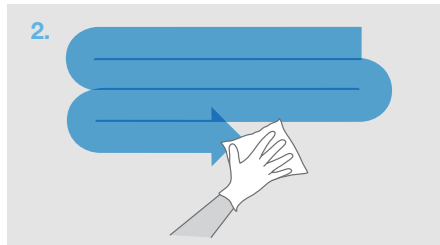

Working from clean to dirty, wipe in an 'S' shaped pattern, taking care not to go over the same area twice.

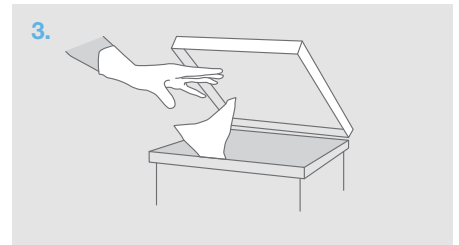

Change wipe if it becomes dry or soiled and dispose of in the appropriate waste bin. Let the surface air dry.

## Reducing transference

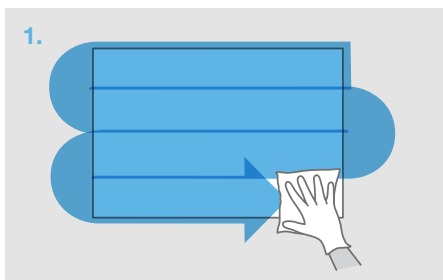

Wipe in an 'S' shaped pattern, from clean to dirty, to avoid wiping over a previously cleaned area. This reduces the amount of microorganisms that can move from a soiled area onto a clean area, within the surface.

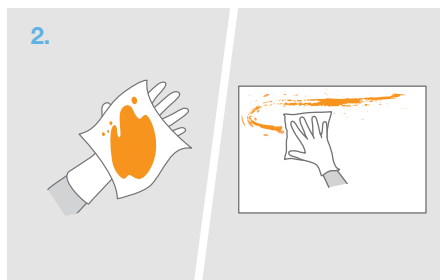

The microorganisms are retained on the wipe after cleaning.

Never wipe two surfaces with one wipe as this will transfer microorganisms from one surface to another.

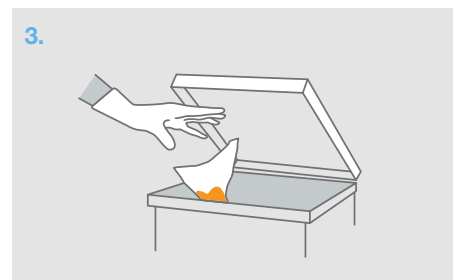

Always dispose of a wipe after it becomes soiled, or in between the cleaning of two surfaces to avoid transferring microorganisms from one area to the next.



Consistently delivers a stable, effective dose.

## Everyday surface care

Clinell offers a complete range of products to clean and disinfect surfaces and medical devices. Whether you need a powerful environmentally friendly detergent, a proven combined wipe which cleans and disinfects, or the rapid acting low-smear disinfection of alcohol wipes – Clinell has the best solution for you.

# UNIVERSAL RANGE

Wipes for surface disinfection and cleaning of non-invasive medical devices.



## The most effective universal formula on the market

A mix of biocides with different mechanisms of action prevents bacterial resistance and superbug formation<sup>28</sup>.

## Multi-purpose

Acts as both a disinfectant and detergent, replacing the need for different types of wipes and surface cleaners.

## Cost effective

Saves money by replacing multiple cleaning products.

## Proven to be bactericidal, virucidal and fungicidal

Effective against MRSA, *E. coli*, *A. baumannii*, VRE, *K. pneumoniae*, Norovirus, *P. aeruginosa*, Hepatitis B & C and many more.

## Excellent material compatibility profile

Ideal for use on mattresses and safe to use on most types of rubber, plastic and metal.

## Clip opening to prevent drying

Keeping your wipes wetter for longer so they remain effective.

## Simple, easy and reliable

The pre-measured dose consistently delivers the correct concentration. This avoids dilution errors that may occur when mixing disinfectant solutions.

## Unique wall mounted dispensers

Hygienic and accessible, for quick and easy wipe dispensing. Proven to increase compliance and provide effective wipe usage by conveniently placing wipes at their point of use.

Use biocides safely. Always read the label and product information before use. Check manufacturer's guidelines before cleaning equipment with this product.

\* **CE 0473** Class IIa Medical Device

PRODUCT	UNIT OF ISSUE	ORDER CODE
Universal Wipes 40	Pack of 40	CW40
Universal Wipes Clip Pack 50 *	Pack of 50	CWCP50
Universal Wipes Adhesive Back 50 *	Pack of 50	CWAB50
Universal Wipes Tub 100 *	Tub of 100	CWTUB100
Universal Wipes Tub Refill 100 *	Refill of 100	CWTUB100R
Universal Wipes 200 *	Pack of 200	CW200
Universal Wipes Bucket 225 *	Bucket of 225	CWBUC225
Universal Wipes Bucket Refill 225 *	Refill of 225	CWBUC225R
Universal Spray 500*	500ml single unit	CDS500
Universal Spray 750*	750ml single unit	CDS750
Universal Wall Mounted Dispenser	for CW200	CUD
Universal Wall Mounted Dispenser	for CWTUB100	CWTUB100D
Universal Wall Mounted Dispenser	for CWBUC225	CWBUC225D

BACTERIA	TEST
<i>Acinetobacter baumannii</i>	EN13727
<i>Enterococcus faecalis</i>	EN13727
<i>Enterococcus faecium</i> (VRE)	EN13727
<i>Enterococcus hirae</i>	EN13727
	EN14561
<i>Escherichia coli</i>	EN13727
<i>Klebsiella pneumoniae</i>	EN13727
Methicillin Resistant <i>Staphylococcus aureus</i> (MRSA)	EN13727
<i>Pseudomonas aeruginosa</i>	EN13727
	EN14561
<i>Staphylococcus aureus</i>	EN13727
	EN14561
<i>Vibrio cholerae</i>	EN1276
<b>MYCOBACTERIA</b>	
<i>Mycobacterium bovis</i>	EN14348
<i>Mycobacterium terrae</i>	EN14348
	EN14563
<b>FUNGI</b>	
<i>Aspergillus brasiliensis</i>	EN13697
	EN14562
<i>Candida albicans</i>	EN13727
	EN14562
<i>Candida auris</i>	EN13624
<b>VIRUSES</b>	
H1N1 and H3N2	EN14476
Hepatitis B	ASTM E1052
Hepatitis C	EN14476
Norovirus	EN14476
HIV	EN14476
MERS-CoV	EN14476

# ALCOHOL WIPES

Ultra quick drying, low-smear disinfection wipes for surface disinfection of non-invasive medical devices.



## Superior quality

Our flow wrap wipes contain 25gsm non-woven spun bond, which is wetter and thicker than competitor alcohol wipes, meaning you can disinfect larger areas with less wipes, saving both time and money.

## Kills 99.999% of germs

Includes *S. aureus*, *P. aeruginosa* and *E. hirae* according to EN13727 and EN14561.

## Generous size

These large wipes are easy to use and an ideal size for effective surface disinfection of non-invasive medical devices.

## Low-smear

The pharmaceutical grade isopropyl alcohol evaporates quickly and is low-smearing, making it perfect for surfaces such as glass, stainless steel and monitor screens. Some competitors use cheaper low grade alcohol with impurities which can smear and leave residue.

## Unique flow wrap design

Brings alcohol wipe packaging into the 21st century: wipes are dispensed one at a time, so the top of the next wipe is not dry – common with tub dispensers – eliminating the infection control risk of dry, contaminated wipes. There is also much less packaging to dispose of compared to standard alcohol tubs, making them more environmentally friendly.

## Alcohol wipes

Clinell Alcohol Wipes are high quality durable wipes, saturated with high quality pharmaceutical grade 70% isopropyl alcohol. Our wipes act as a rapid, low-smear disinfectant for surfaces and equipment, with a proven bactericidal action.

**Clinell's rapid, low-smear disinfectant kills at least 99.999% of germs**

**CE 0473** Class IIA Medical Device

BACTERIA	TEST
<i>Enterococcus hirae</i>	EN14561 EN13727
<i>Staphylococcus aureus</i>	EN14561 EN13727
<i>Pseudomonas aeruginosa</i>	EN14561 EN13727



Dispensers are available for: CAW100L & CAW150L

Check manufacturer's guidelines before cleaning equipment with these products.

PRODUCT	UNIT OF ISSUE	ORDER CODE
Alcohol Wipe Sachets 100	Box of 100	CASS100
Alcohol Wipes Large 100	Pack of 100	CAW100L
Alcohol Wipes 150	Pack of 150	CAW150L
Wall Dispenser	(for CAW100L/CAW150L)	CAWD

# 2% CHLORHEXIDINE IN 70% ALCOHOL

Wipes for the disinfection of non-invasive medical devices such as venous and arterial catheters, peripheral cannulas, needleless connectors and blood culture bottle caps.



## Better than traditional methods

Proven to be superior to both 70% alcohol and 10% povidone-iodine for preventing central venous and arterial catheter related infections<sup>29,30</sup>.

## Proven reduction

Proven to reduce catheter-related blood stream infections by 75%<sup>31,32</sup>.

## Fast acting, long lasting

Provides the benefit of rapid antimicrobial action and excellent residual activity.

## Proven efficacy

Proven to be effective at disinfecting central venous catheter hubs and sampling ports<sup>33</sup>.

## Complies with guidelines

Conforms to guidelines for preventing infections associated with the maintenance of central venous catheters. As outlined in: EPIC 3<sup>34</sup>, NICE<sup>35</sup>, UK Department of Health High Impact Interventions<sup>36</sup> and CDC<sup>37</sup>.

## UK Department of Health High Impact Interventions

### CENTRAL VENOUS CATHETER CARE BUNDLE

Catheter access - ports or hubs are cleaned with 2% chlorhexidine digluconate in 70% isopropyl alcohol prior to catheter access.

### PERIPHERAL INTRAVENOUS CANNULA CARE BUNDLE

Cannula access - 2% chlorhexidine digluconate in 70% isopropyl alcohol is used to decontaminate the port prior to administering fluid or injections via the cannulae.

### RENAL HAEMODIALYSIS CATHETER CARE BUNDLE

Catheter access - ports or hubs are cleaned with 2% chlorhexidine digluconate in 70% isopropyl alcohol prior to catheter access.

### TAKING BLOOD CULTURES

Clean the tops of culture bottles with a 2% chlorhexidine digluconate in 70% isopropyl alcohol impregnated swab and allow to dry for 30 seconds.

**Powerful cleaning  
formula, containing 2%  
chlorhexidine gluconate  
and 70% isopropyl alcohol**

## EPIC 2 Project Guidelines<sup>38</sup>

### THE EPIC 2 PROJECT GUIDELINES FOR PREVENTING INFECTIONS ASSOCIATED WITH THE USE OF CENTRAL VENOUS CATHETERS

Bloodstream infections associated with the insertion and maintenance of central venous catheters (CVC) are among the most dangerous complications of healthcare that can occur. They worsen the severity of the patients' underlying ill health, prolonging the period of hospitalisation and increasing the cost of care.

### The EPIC 2<sup>38</sup> & EPIC 3<sup>34</sup> project report concluded:

**CVC33** - Preferably, an alcoholic chlorhexidine digluconate solution should be used to decontaminate the injection port or catheter hub before and after it has been used to access the system.

**CVC44** - When needleless devices are used, the risk of contamination should be minimised by decontaminating the access port with an alcoholic chlorhexidine digluconate solution.

**IVAD30** - A single-use application of 2% chlorhexidine digluconate in 70% isopropyl alcohol (or povidone iodine in alcohol for patients with sensitivity to chlorhexidine) should be used to decontaminate the access port or catheter hub. The hub should be cleaned for a minimum of 15s and allowed to dry before accessing the system.

**CE 0473** Class IIa Medical Device

Check manufacturer's guidelines before cleaning equipment with this product.

PRODUCT	UNIT OF ISSUE	ORDER CODE
2% Chlorhexidine in 70% Alcohol Wipes	Box of 240 wipes	CA2C240

# DETERGENT RANGE

Multi-surface wipes for general cleaning and damp dusting. They leave ultra low-smear whilst providing a superior level of cleaning power.



## Cutting edge technology combined with ease of use to create an incredibly effective and environmentally friendly formula

### Unique new patent pending formula

Derived from renewable and sustainable plant sources, Clinell Detergent Wipes are natural with ultra low-smear.

### Optimum cleaning

Even stronger cleaning power, developed specifically for use in healthcare environments.

### Multi-surface cleaning

Can be used on both surfaces and equipment including: mattresses, bed frames, table tops, door handles, desks, chairs, ledges, examination couches, telephones, keyboards and accessories, wheelchairs, trolleys, walking frames etc.

### Alcohol & disinfectant free

Gentle formula, designed for frequent, everyday use.

### Convenient and effective

Disposable wipes that are ideal for general cleaning and damp-dusting.

### Unique wall mounted dispensers

Hygienic and accessible, for quick and easy wipe dispensing. Proven to increase compliance and provide effective wipe usage by conveniently placing wipes at their point of use.

PRODUCT	UNIT OF ISSUE	ORDER CODE
Detergent Wipes Clip Pack 60	Pack of 60	CDCP60
Detergent Wipes Tub 110	Tub of 110	CDT110
Detergent Wipes Tub Refill 110	Refill of 110	CDT110R
Detergent Wipes 215	Pack of 215	CDW215
Detergent Wipes Bucket 260	Bucket of 260	CDB260
Detergent Wipes Bucket Refill 260	Refill of 260	CDB260R
White Wall Mounted Dispenser	(for CDW215)	CDWDW
Wire Wall Mounted Dispenser	(for CDT110)	CDT100D
Wire Wall Mounted Dispenser	(for CDB260)	CDB260D



Dispensers are also available for tubs and buckets.

Check manufacturer's guidelines before cleaning equipment with these products.



Proven to reduce  
incidence of  
*C. difficile* infection.

## High-level disinfection

Clinell provides effective and proven sporicidal solutions. Clinell Sporidical Wipes' patented technology generates peracetic acid and has a proven six log spore kill, in a two-minute contact time, in dirty conditions<sup>39</sup>. There is also a complete, one-step solution to body spills in Body Spill Wipes, all with sporicidal action from Clinell.

# DRY BIOFILMS

Dry biofilms pose significant challenges in clinical settings because they protect organisms contained within them. They are difficult to eradicate and are invisible to the naked eye<sup>40</sup>.

## Biofilms within healthcare settings

### MICROORGANISM ACCUMULATION

Microorganisms accumulate and attach to surfaces forming communities known as biofilms<sup>41</sup>. It is thought that biofilm formation provides protection and nutrients for microorganisms allowing them to survive in hostile environments<sup>40</sup>.

### DIFFICULT TO REMOVE

Biofilms are difficult to remove and survive decontamination methods previously thought to be effective in environmental decontamination<sup>42</sup>. The presence of dry biofilms harbouring bacterial pathogens is virtually universal on commonly used items in healthcare<sup>3</sup>. Many existing disinfectants do not demonstrate efficacy against dry biofilms.

### FOUND ON COMMONLY USED HEALTHCARE ITEMS<sup>3</sup>:

- Patient folders
- Clipboards
- Chairs
- Commodes
- Sanitising bottles
- Trolleys
- Keyboard keys

## Measuring efficacy against dry biofilms

In collaboration with Cardiff University we have developed a method that has enabled measurement of the efficacy of Clinell Sporicidal Wipes against dry biofilms based on transferability, regrowth and removal<sup>43</sup>.

### TRANSFERABILITY

Determines how well pathogens from dry biofilms can transfer to other surfaces post-wiping.

### REGROWTH

Measures the time needed for a treated biofilm to regrow.

### REMOVAL

Log reduction gives the number of bacteria that are removed following wiping.



# SPORICIDAL WIPES

Peracetic acid generating wipes, activated by water, for surface disinfection and cleaning of non-invasive medical devices.



## Patented formula

Comes in a stable form that delivers peracetic acid on demand. Peracetic acid is a safe alternative to chlorine, and is proven to provide similar or better performance against spores compared to chlorine<sup>26</sup>.

## Simple and easy to use

Just wet with water to activate the dry wipes. No more dilution errors. It generates no toxic fumes and can be used next to patients.

## The most powerful wipe in the world

Clinell Sporocidal Wipes kills all known pathogenic microorganisms with a non-specific kill action. They have a proven 6 log spore kill, in two minutes, in dirty conditions<sup>39</sup>. Proven to outperform other leading sporicidal wipes<sup>44</sup>.

## Cost efficient

Proven to save up to £660,000 per annum<sup>45</sup>.

## Contains detergent

Clinell Sporocidal Wipes cleans and disinfects. Peracetic acid remains effective in highly soiled conditions – unlike chlorine and glutaraldehyde based products, which are inhibited by dirt and organic matter<sup>26</sup>.

## Safe to use on most surfaces

Clinell Sporocidal Wipes are a CE-certified class IIa medical device. They can be used on non-invasive medical devices and equipment without corrosion, unlike chlorine solutions.

## Unique wall mounted dispensers

Hygienic and accessible for quick and easy wipe dispensing. Proven to increase compliance and provide effective wipe usage by conveniently placing wipes at their point of use.

BACTERIA	TEST
<i>Acinetobacter baumannii</i>	EN13727
<i>Escherichia coli</i>	EN13727
<i>Pseudomonas aeruginosa</i>	EN1276
	EN14561
<i>Staphylococcus aureus</i>	EN13727
	EN14561
<i>Enterococcus hirae</i>	EN13727
	EN14561
<i>Klebsiella pneumoniae</i> (ESBL)	EN13727
<i>Enterococcus faecalis</i>	EN13727
<i>Enterococcus faecium</i> (VRE)	EN13727
<b>SPORES</b>	
<i>Clostridioides difficile</i>	ASTM E2362-09
	EN13704
	EN17126
<i>Bacillus subtilis</i>	Bab et al <sup>39</sup>
	EN17126
	EN13704
<b>MYCOBACTERIA</b>	
<i>Mycobacterium terrae</i>	EN14563
<i>Mycobacterium bovis</i>	EN14348
<i>Mycobacterium avium</i>	EN14348
<b>FUNGI</b>	
<i>Candida albicans</i>	EN14562
	EN13727
<i>Aspergillus brasiliensis</i>	EN14562
<b>VIRUSES</b>	
Adenovirus	EN14476
Poliovirus	EN14476
Canine Parvovirus	EN14476
MERS-CoV	EN14476

## Antimicrobial activity

Powerful disinfecting composition using a pH optimised peracetic acid and hydrogen peroxide combination, generated from sodium percarbonate and tetra acetyl ethylene diamine.

High power oxidative kill against all microorganisms including non-enveloped viruses and bacterial endospores.

Greater than 6 log kill (>99.9999%) of spores in two minutes in dirty conditions<sup>39</sup>. Conforms to EN13704, EN14348, EN14476, EN14561, EN14562, EN14563 and EN1650.

**CE 0473** Class IIa Medical Device

Check manufacturer's guidelines before cleaning equipment with this product.

Proven to reduce *Clostridioides difficile* associated disease by **72%**<sup>45</sup>



PRODUCT	UNIT OF ISSUE	ORDER CODE
Sporocidal Wipes	Pack of 25	CS25
Sporocidal Wall Mounted Dispenser	(for CS25)	CS25D

# SPORICIDAL GRANULES

Peracetic acid generating technology for high level disinfection and cleaning of floors and large areas.



## Uses Peracetic Acid (PAA) Technology

PAA generating products are now considered a suitable alternative in situations where 1,000 and 10,000 ppm of chlorine are recommended<sup>26</sup>.

## Unique granule formulation

Easily mixed within a bespoke 1L or 2.5L mixer allowing quick and easy activation, avoiding dilution errors common with chlorine tablets.

## ColourActive™ Technology

Once active the solution turns red in colour. When no longer active it becomes colourless, allowing you to always know you are using an effective solution.

## More effective than chlorine

PAA has been shown to be more effective than chlorine against *C. difficile*<sup>46,47</sup> and unlike chlorine, PAA is not deactivated by organic matter<sup>48,49</sup>.

## Safer than chlorine

Peracetic acid breaks down into the harmless, environmentally friendly by-products of water, carbon dioxide and oxygen.

## New evidence shows that flooring can be a reservoir for pathogens of significance in healthcare<sup>50,51,52</sup>.

\* Only available outside Europe. Check manufacturer's guidelines before cleaning equipment with this product. Use biocides safely. Always read the label and product information before use.

PRODUCT	SIZE	ORDER CODE
Sporidical Granules * (for use with 1L mixer)	30g	CSG30
Sporidical Granules * (for use with 2.5L mixer)	75g	CSG75

Individual 1L and 2.5L mixers are also available.

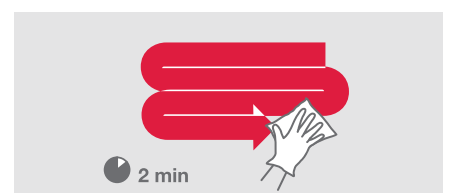
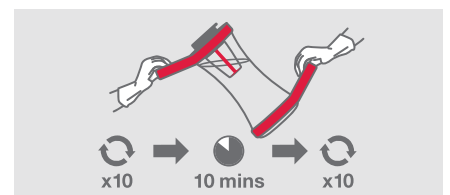
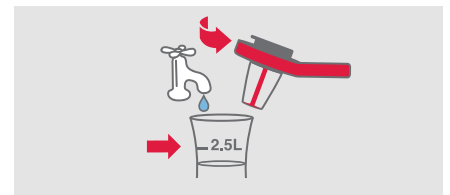
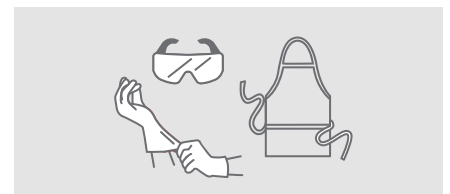

NEW

# DRAIN DISINFECTANT

Foaming peracetic acid generating granules for cleaning and high level disinfection of sink and shower drains.



**Clinell Drain Disinfectant's unique formulation breaks down stubborn biofilms and kills 99.9999% of bacteria, including hard-to-eradicate pathogens such as Klebsiella, Pseudomonas and Enterobacter<sup>53,54</sup>.**

## Fast-acting and long-lasting

Clinell Drain Disinfectant takes only 15 minutes to eradicate even the most persistent of biofilms. It then prevents regrowth for at least 4 days.

## More effective than chlorine

Whilst 'traditional' chlorine based treatments only kill the bacteria living close to and around the sink outlet - allowing them to regrow quickly - foaming Clinell Drain Disinfectant tackles both the bacteria and the biofilms in which they thrive, all the way down through the drainage trap.

## Save time and money

After initial usage of three consecutive days, use Clinell Drain Disinfectant twice weekly to prevent the regrowth of biofilms, helping to prevent healthcare-associated infections and potential water-related outbreaks of infection. Use as part of your planned preventative maintenance programme to avoid ward closures and costly maintenance and replacement costs.

## Cutting-edge research

Working in collaboration with researchers at Cardiff University we are pioneering new and innovative ways to tackle biofilms in the healthcare environment<sup>55</sup>.

## Compatibility

Clinell Drain Disinfectant has been formulated with compatibility in mind. Unlike other chlorine based disinfectants, it can be used regularly, without the worry of causing damage to the sink or drainage system.

## The solution

Powered by a unique formulation based on our patented Sporidical Wipes, Clinell Drain Disinfectant uses foaming peracetic acid (PAA) to target both the bacteria and the slimy build-up of biofilm in which they survive and multiply<sup>56</sup>.

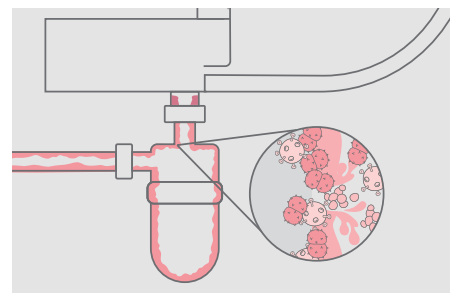

Multi-drug resistant bacteria found in these biofilms result in healthcare associated infections<sup>57,58</sup>.

Clinell Drain Disinfectant destroys biofilms, including highly-resistant Gram-negative species, all the way through the drainage system, preventing regrowth for at least four days.

## Kills, removes and prevents biofilms

PRODUCT	SIZE	ORDER CODE
Drain Disinfectant	24 x 30g	CSDD24
Drain Disinfectant Indicator Tape	Single unit	CST90

# SPILL WIPES

Designed to make dealing with body fluid spills quick and easy. The pack contains one super absorbent, peracetic acid generating pad and two large disinfectant wipes. All within a resealable bag for the easy and safe disposal of waste.



The traditional body fluid spills protocol requires the spill to be decontaminated with chlorine before the spill can be safely removed. This involves a lengthy procedure: placing a barrier agent around the edges of the spill and using a chlorine solution to neutralise the fluid-borne pathogens.

This entire process takes at least 10 minutes and exposes the user to hazardous chemicals and toxic fumes – which may explain why compliance is very low with current chlorine blood spill kits. In addition, certain chlorine spill kits cannot be used on urine – meaning two different spill kits for blood and urine are necessary. With Clinell Spill Wipes only one kit is required.

Clinell Spill Wipes were created to make the entire process of dealing with body fluid spills quicker, easier and safer. They increase compliance with this often neglected procedure in a cost effective manner.

## Proven to kill all known microorganisms associated with blood, urine and faecal spills

High power oxidative kill against all microorganisms including non-enveloped viruses and bacterial endospores including Hepatitis B & C, HIV, *Clostridioides difficile*, Norovirus and many more. Conforms to EN1276, EN13704, EN14348, EN14476, EN14561, EN14562 and EN14563.

## Proven to kill all known microorganisms associated with blood, urine and faecal spills

## Simple, quick and highly effective

Replacing traditional chlorine based spill kits which are time consuming and hazardous to use. The exceptional ease of use increases compliance, reducing incidence of pathogen transmission.

## Easy and safe disposal of soiled wipes

Clinell Spill Wipes packaging is designed so that all items, including protective clothing worn by the user, can be disposed of in the re-sealable bag and placed into the appropriate disposal channel.

## Based on technology from the most powerful wipe in the world

Similar to Clinell Sporidical Wipes, the super absorbent pad generates peracetic acid and hydrogen peroxide on activation. This proven formula creates no toxic fumes or harmful residual by-products, making it safe to use in patient areas. In addition, it is safe to use on urine – unlike traditional chlorine based products.

PRODUCT	UNIT OF ISSUE	ORDER CODE
Spill Wipes	Single unit	CSW1
Wall Mounted Dispenser	(for CSW1)	CSWD



Use biocides safely. Always read the label and product information before use. Check manufacturer's guidelines before cleaning equipment with this product.



Improved patient cleanliness is proven to reduce microbial burden.

## Skin care

After 7 days in hospital, 62% of all patients were positive for enterococcal hand contamination<sup>9</sup>. Within 48 hours 39% of all patients had at least one HCAI causing pathogen on their hands<sup>10</sup>.

Improved patient cleanliness, specifically the hands, reduces the number of microorganisms available to transfer to healthcare workers and visitors. Our hand products are designed for frequent use, to keep skin healthy and hygienically clean.

# ANTIMICROBIAL HAND WIPES

Antimicrobial wipes for cleaning and disinfecting hands. The patented formula kills 99.999% of germs without the need for soap and water.



## Bactericidal and fungicidal in seconds

A mix of biocides with different mechanisms of action prevent bacterial resistance and superbug formation<sup>28</sup>.

## Can be used on 'soiled, visibly dirty hands'

The wipes contain surfactants to remove dirt, unlike alcohol gel rubs, which can only be used on 'visibly clean hands'<sup>59</sup>.

## PHMB-free formula

Developed to provide the best protection from germs.

## Conforms to PLACE, EPIC 3 and NHS choices guidance

Recommended for use before eating and after using the toilet. Perfect for patient food trays.

## For carrying with you at all times

Conveniently sized, individual sachets are ideal for personal carry at all times – at home, in the office, in the car, in bags or when travelling.

## Patient hand hygiene represents the next big step in infection prevention<sup>60</sup>

## Antimicrobial Hand Wipe Dispensers

### DELIVER GOOD HAND HYGIENE - AT THE POINT OF USE

Clinell's dispenser system has been proven to increase compliance and provide effective wipe usage by conveniently placing wipes where they are most frequently used.

### HYGIENIC PULL SYSTEM

No need to touch the dispenser with dirty hands. Simply pull on the next available individually wrapped sachet.

### QUICK SELF INSTALLATION

Comes equipped with ready to use, super strong, adhesive tape for quick and easy self installation.

### EASY-CLEAN DISPENSER

Smooth, easy clean, high density plastic reduces bacteria reservoirs.

### SIMPLE REFILL SYSTEM

Simple design allows for quick refilling with new wipes.

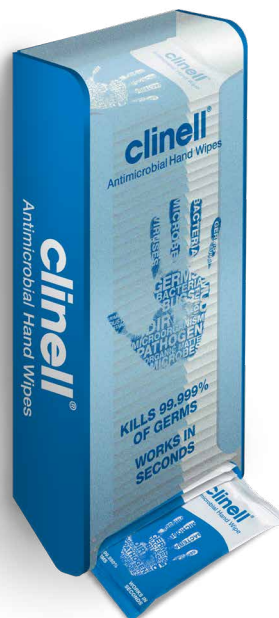

PRODUCT	UNIT OF ISSUE	ORDER CODE
Antimicrobial Hand Wipes	Box of 100	CAHW100
Antibacterial Hand Wipes	Pack of 200	CAHW200
Antimicrobial Hand Wipe Dispenser	(for CAHW100)	CAHWD

Use biocides safely. Always read the label and product information before use.

BACTERIA	TEST
<i>Acinetobacter baumannii</i>	EN13727
<i>Escherichia coli</i>	EN13727
<i>Pseudomonas aeruginosa</i>	EN13727
<i>Staphylococcus aureus</i> (MRSA)	EN16615
<i>Enterococcus hirae</i>	EN13727
<i>Klebsiella pneumoniae</i> (ESBL)	EN16615
<i>Enterococcus faecalis</i>	EN13727
<i>Enterococcus faecium</i> (VRE)	EN13727
Carbapenem Resistant <i>Enterobacteriaceae</i> (CRE)	EN13727
<i>Vibrio cholerae</i>	EN13727
<i>Leptospira interrogans</i> (Weil's Disease)	EN1656
<i>Proteus vulgaris</i>	EN1656
<i>Bordetella bronchiseptica</i>	EN1656
FUNGI	
<i>Candida albicans</i>	EN13624
	EN16615
<i>Candida auris</i>	EN13624
MYCOBACTERIA	
<i>Mycobacterium bovis</i>	EN14348
<i>Mycobacterium smegmatis</i>	EN14348
<i>Mycobacterium terrae</i>	EN14348
VIRUSES	
Adenovirus	EN14476
	EN16777
Norovirus	EN14476
	EN16777
HIV	EN14476
Hepatitis B	ASTM E1052
Hepatitis C	EN14476
Influenza (H1N1)	EN 14476

# HAND SANITISING GELS

Gel for instantly disinfecting hands without the need for soap and water. Containing a unique blend of 70% alcohol and moisturisers.



## Provides a superior level of effectiveness against germs

### Unique formula

Specifically designed for use within the healthcare sector to kill germs and instantly sanitise hands.

### Dermatologically tested

The gels contain moisturiser to promote healthy, soft skin.

### Ideal to use before eating

Safe to eat food with hands after application once the hands have dried naturally.

### Cleans and refreshes

With natural extracts of aloe vera.

### Instant results

Ideal for healthcare settings.

### Superior effectiveness

Alcohol based formula provides a superior level of effectiveness against germs and prevent bacterial resistance.

### Travel size

The 50ml gel's small and convenient size makes it ideal for carrying with you at all times – at home, in the office, in your car, in your handbag or when travelling. Also available with a convenient belt clip and retractable lead to ensure that your gel is always to hand (CHSGTOT50).



Use biocides safely. Always read the label and product information before use.

PRODUCT	UNIT OF ISSUE	ORDER CODE
Hand Sanitising Gel with extendable clip	50ml single unit	CHSGTOT50
Hand Sanitising Gel flip top	50ml single unit	CHSG50
Hand Sanitising Gel flip top	100ml single unit	CHSG100
Hand Sanitising Gel pump dispenser	250ml single unit	CHSG250
Hand Sanitising Gel pump dispenser	500ml single unit	CHSG500

# 2% CHLORHEXIDINE IN 70% ALCOHOL SKIN WIPES

Wipes for cleaning skin after dressing and plaster removal, especially where the dressing has caused dirt to develop.



## Reduces risk of infections

Cleaning with the Clinell 2% Chlorhexidine in 70% Alcohol Skin Wipes helps to reduce the bacteria that can cause skin infections.

## Individually wrapped wipes

Pre-saturated wipes designed for cleaning small areas of skin.

## Dermatologically tested

Clinell 2% Chlorhexidine in 70% Alcohol Skin Wipes have no added latex, designed to be kind to skin.

## Stronger cleaning power

Effective in removing stubborn adhesive residue.

## Range of uses

Ideal for cleaning skin after dressing and plaster removal, especially where the dressing has caused dirt to develop. In certain countries outside of the EU, it can be used as part of a medical procedure depending on the appropriate registration and local regulations e.g. as a pre-injection swab according to local regulations.

## Directions for use

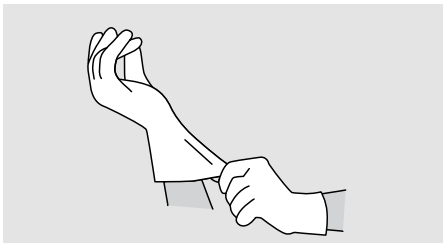

Wear the appropriate PPE.

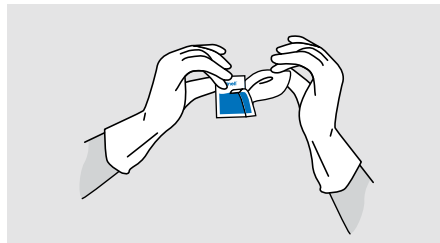

Tear open one sachet and remove the wipe.

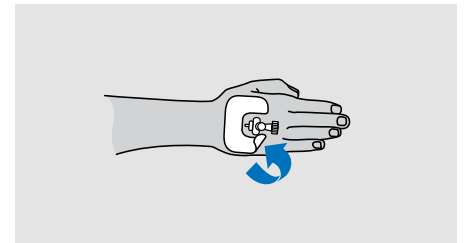

Remove any plasters or medical equipment from the area to be cleaned.



Wipe the area to be cleaned thoroughly.

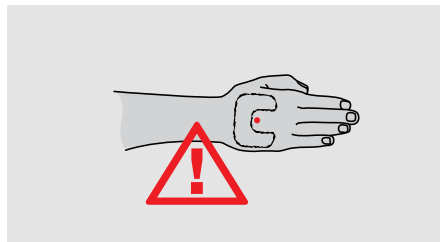

Be careful not to use the wipe on open wounds.



Discard the soiled wipe in the appropriate waste channel.

Use biocides safely. Always read the label and product information before use.

PRODUCT	UNIT OF ISSUE	ORDER CODE
2% Chlorhexidine in 70% Alcohol Skin Wipes	Box of 200 wipes	CA2CSKIN

**Powerful cleaning formula containing 2% chlorhexidine digluconate and 70% isopropyl alcohol.**



# MEATAL CLEANSING WIPES

NEW

Sterile wipes to cleanse, protect and support aseptic catheterisation procedures to help reduce the risk of CAUTI.



## Evidence based

An Australian study published in the Lancet Infectious Diseases, shows replacing 0.9% sterile saline with 0.1% chlorhexidine reduces incidence of catheter associated urinary tract infections (CAUTI) by 94%<sup>61</sup>.

## Better than traditional methods

Simplifies the traditional method of soaking gauze in a solution with a one step process.

## Easy to use

HEXI CATH wipes are pre-saturated and designed to fit into your local protocols without the need for extensive training.

## Cost & time effective

A recent study has shown that replacing 0.9% saline with chlorhexidine could save £218,000 per 100,000 catheterisations<sup>62</sup> - saving time, patient bed days and associated costs.

## Gentle on skin

HEXI CATH wipes are made from spun lace and are designed to be super soft for maximum patient comfort.

**9,000 deaths per year from CAUTI<sup>61</sup>.**

**HEXI CATH is a sterile wipe containing 0.1% chlorhexidine, designed to be used as part of the aseptic cleaning procedure of the urethral meatus prior to urinary catheterisation. The concept of cleaning the urethral meatal area is to reduce the risk of introducing bacteria during catheterisation.**

## Why consider changing current practice?

Replacing 0.9% sterile saline, as recommended by EPIC 3 guidelines, with 0.1% chlorhexidine, reduced the incidence of CA-ASB by 74% and CAUTI by 94%<sup>61,62</sup>.

## Different approaches

EPIC 3 Guidelines (2014) apply to adults and children who require a short-term indwelling urethral catheter. These guidelines were published before more recent work on 0.1% chlorhexidine. Before this paper, the evidence on 0.9% sterile saline as a cleansing agent was limited and not very robust. This new paper, the largest clinical study of its kind, has proven that replacing sterile saline with a 0.1% chlorhexidine solution significantly improves outcomes.

## The solution

0.1% chlorhexidine is safe to use on the meatal area. The sterile nature of the impregnated wipe aligns to principles of asepsis during catheter insertion and provides assurance that the meatal area has been cleansed with confidence to reduce the risk of introducing bacteria during the insertion process.

**94% reduction in catheter-associated urinary tract infections<sup>61</sup>.**

PRODUCT	UNIT OF ISSUE	ORDER CODE
HEXI CATH 50	Box of 50	HC50



Increase compliance  
and improve patient  
experience.

## Patient bathing products

An increased level of patient hygiene can improve patient well-being and reduce the number of microorganisms that are available to transfer to healthcare workers and visitors.

# OVERCOMING PROBLEMS WITH WASH BASINS

In 88 US hospitals, 62.2% of bath basins were contaminated with commonly encountered hospital-acquired pathogens<sup>63</sup>.



## The advantages of wipes

### SAFE SOLUTION

Clinell Patient Bathing Wipes remove the risk of microorganism transmission associated with wash bowl contamination. Using wipes also reduces the associated risk of lifting and carrying heavy bowls of water such as spills and falls<sup>63,64</sup>.

### QUICK AND EASY TO USE

Wipes replace the need for cumbersome traditional patient cleansing methods which include preparing bowls, wash cloths, soap, lotions and water. They require no towel drying which decreases waste, whilst increasing staff compliance and saving time and money.

### REDUCES TRANSFERENCE

Improved patient cleanliness reduces the number of microorganisms available to transfer to healthcare workers, visitors and the environment.

## Wash basins



1. Wash basins can create spills which can lead to slips and accidents.

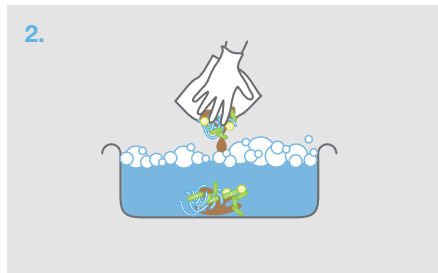

2. When a cloth is dipped back into the basin, organic matter and bacteria is introduced.



3. When the basin is emptied, microorganisms can be retained within the basin.

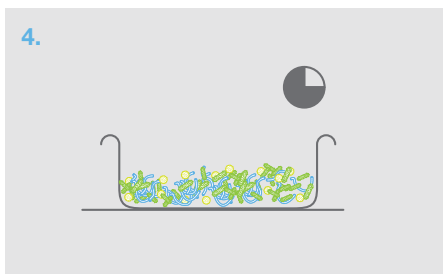

4. Microorganisms thrive in wet and warm conditions, multiplying exponentially over time.

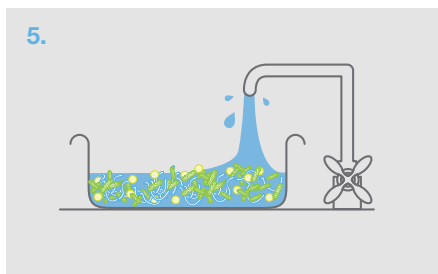

5. When the basin is refilled for the next patient, the microorganisms are viable within the water.



6. The next patient is 'cleaned' with contaminated water.

# CHLORHEXIDINE BATHING RANGE

Large, disposable, antiseptic, all-over body cleansing cloths and shampoo cap provides the perfect solution for pre-admission or ITU bathing.



## Residual protection for up to six hours

Clinell Chlorhexidine Wash Cloths contain 2% chlorhexidine digluconate which reduces harmful bacteria that can be found on your skin. It also binds to your skin for many hours after application, providing hours of residual protection.

## Use hot or cold

Use at room temperature or place in a Clinell Warmer for a warm wash cloth in seconds.

## Provides rapid bactericidal action

Helps to protect against a wide variety of microorganisms that cause infections.

## Antibacterial barrier

Unlike conventional soaps and body washes, the binding of the chlorhexidine acts like an invisible, antibacterial barrier which continues to reduce bacteria on your skin for many hours. This gives you an extra level of protection during your hospital stay and procedures.

## Ideal for bed baths in an ITU setting

Also ideal for pre-admission patients.

## Conforms to EPIC 3 guidelines<sup>34</sup> IVAD21

Consider the use of daily cleansing with chlorhexidine in adult patients with a central venous catheter as a strategy to reduce catheter-related bloodstream infection.

## Full body wash

The pack contains 8 wipes which enables each area to be effectively cleaned without wiping more than one area with a single cloth.

## Why chlorhexidine gluconate is effective:

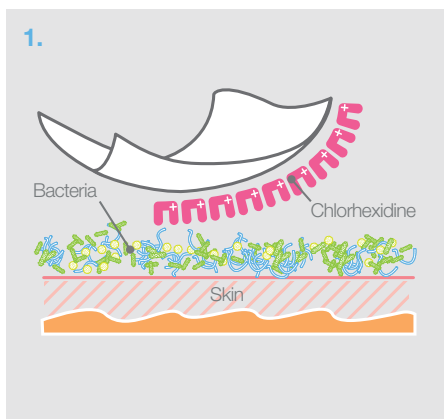

The positively charged chlorhexidine molecule is attracted to the negatively charged cell wall of the bacteria.

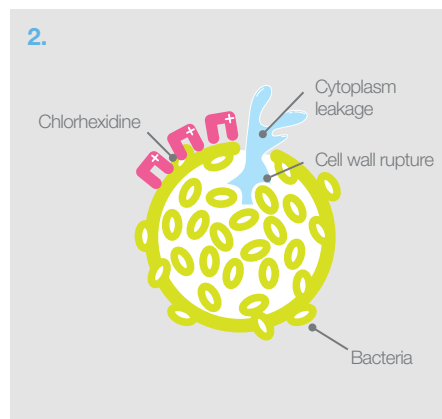

The chlorhexidine binds to the cell wall causing it to rupture, leading to cytoplasm leakage, lysis and cell death.

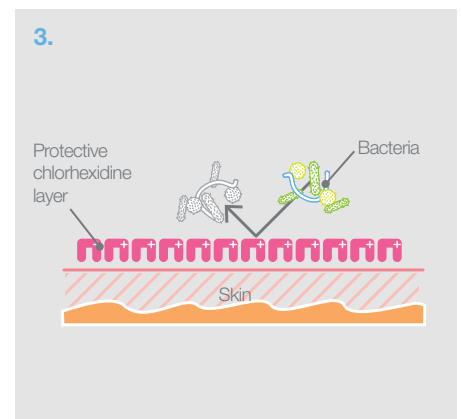

Positively charged chlorhexidine molecules bind to the proteins in human tissues which subsequently releases them slowly to provide a layer of prolonged protection.

**Contains 2% chlorhexidine digluconate which kills the harmful bacteria usually found on skin.**

Use biocides safely. Always read the label and product information before use.

PRODUCT	UNIT OF ISSUE	ORDER CODE
Chlorhexidine Shampoo Cap	Single unit	CHGSC1
Chlorhexidine Wash Gloves	Pack of 8	CHGWGL8
Chlorhexidine Wash Cloths	Box of 12 packs (each containing 8 wipes)	CHGWC8

# BED BATHING RANGE

carell®

Large, soft, rinse-free, cleansing and moisturising wipes for a complete full body bathing solution.



## Full body wash

Large, soft wipes designed for one wipe to be used on each area of the body. For use on the face, neck, chest, arms, perineum, legs, back and buttocks.

## A simple, rinse-free bathing solution

Designed for cleaning and moisturising the body in one easy step.

## A warm bedbath in seconds

Clinell Bedbath Patient Wipes 8 packs can be used at room temperature or placed in a Clinell Warmer.

## Promotes healthy soft skin

Contains aloe vera and added moisturiser.

## Dermatologically tested

Skin neutral pH. Alcohol, lanolin and paraben free.

## Directions for use

### FACE & NECK

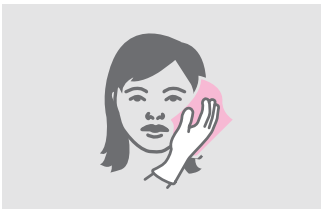

### CHEST

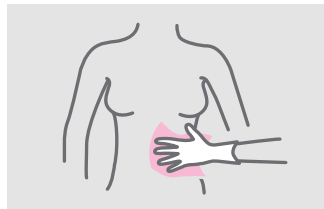

### BACK

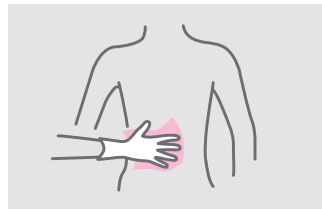

### RIGHT ARM & AXILLA



### LEFT ARM & AXILLA

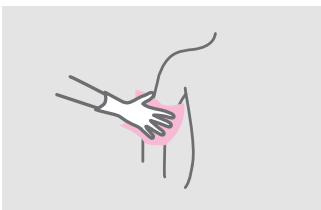

### PERINEUM & BUTTOCKS

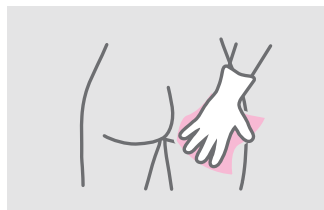

### LEFT LEG



### RIGHT LEG



The Clinell Warmers are suitable for CHGCS1, CHGWC8, PRSHMC1, CBB8 and CBBGL8.

PRODUCT	UNIT OF ISSUE	ORDER CODE
Shampoo Cap	Single unit	PRSHMC1
Bedbath Wipes 8	Pack of 8	CBB8
Bedbath Gloves 8	Pack of 8	CBBGL8
Body Care Wipes 60	Pack of 60	CBC60
Clinell Warmer	Single unit	CWARM
Large Clinell Warmer	Single unit	CTM24

# PERSONAL CARE WIPES

Dermatologically tested wipes with added moisturisers for frequent patient use. Ideal to stay clean and fresh.



## Keeps skin clean and refreshed

Carell Personal Care Wipes are specifically developed to help maintain personal hygiene, for use on hands and face.

## Dermatologically tested formula

Formulated to be gentle on skin, the wipes are designed for frequent use, without causing dryness or irritation to the skin.

## Keep wipes at bedside

Carell Personal Care Wipes 40 pack has an integrated clip, making it easy to attach to the bed and bedside locker. Perfect for convenient access to patient cleansing wipes, helping to keep the patient protected at all times.

## Available in a wide range of pack sizes

Perfect for individual patient use for long or short stays.

## Alcohol, lanolin and paraben free

Carell Personal Care Wipes contain aloe vera and added moisturiser to promote healthy, soft skin.

## Available in maceratable

Safe and easy disposal.

## Effective hand cleaning

Hands must be cleaned after all patient and healthcare worker interactions. Follow the steps below for at least 30 seconds.



1. Rub hands palm to palm.



2. Rub back of each hand with the palm of other hand with fingers interlaced.



3. Rub palm to palm with fingers interlaced.



4. Rub with backs of fingers to opposing palms with fingers interlocked.



5. Rub each thumb clasped in opposite hand using rotational movement.



6. Rub tips of fingers in opposite palm in a circular motion.



7. Rub each wrist with opposite hand.



8. Discard the wipe in the appropriate waste bin.

**39%** of patients have at least one hospital-associated pathogen on their hands within 48 hours of admission<sup>10</sup>

PRODUCT	UNIT OF ISSUE	ORDER CODE
Refreshing Wipes 10	Pack of 10	CRW10
Personal Care Wipes 24	Pack of 24	CHF24
Personal Care Wipes Clip Pack 40	Pack of 40	CPP40

# BARRIER CLEANSING CLOTHS

Effective continence care can help reduce the incidence of incontinence-associated dermatitis and pressure ulcers.

**Skin pH level** is usually slightly acidic (5.0-5.9). This helps it to protect against bacteria, viruses and fungi.

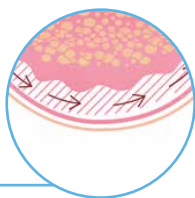

**Continuous pressure** leads to reduced blood flow, reducing supply of oxygen and nutrients to tissues. This, coupled with increasing shear and friction forces, results in superficial and deep tissue damage.

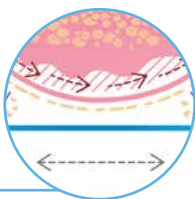

**Urine** contains a substance called urea, which is broken down to ammonia when in contact with the skin. Ammonia raises the pH of the skin reducing the natural barrier and weakening the skin.

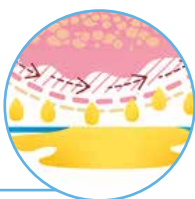

**Liquid stool** contains digestive enzymes that can damage the skin directly. Faecal bacteria penetrate weakened skin, causing secondary infection.



**Incontinence-associated dermatitis (IAD)** is 'an inflammation of the skin that occurs when urine or stool comes into contact with perineal or perigenital skin'<sup>65</sup>.

Individuals in any age group can experience IAD. Skin can be damaged by moisture and irritants that can arise from a variety of sources. One source is urinary and/or faecal incontinence. Urine and faeces contain a variety of chemical irritants as well as moisture, all of which can result in IAD<sup>66</sup>.

Reports estimate the prevalence of IAD in critical care settings may vary from 36% to 50% in patients who are not on a defined preventive skin care regime<sup>67,68</sup>.

IAD is a prevalent complication of incontinence that compromises skin integrity, predisposes to cutaneous infection and increases pressure ulcer risk<sup>65</sup>.

It is estimated that one in five hospital inpatients has a pressure ulcer – this represents at least 20,000 hospital patients in the UK at any time. In the UK, around 400,000 individuals develop a new pressure ulcer annually. The cost to the NHS is high, primarily because prolonged hospital treatment is needed in serious cases and those at risk must be protected. The annual cost is in the range of £1.8–2.6bn<sup>69</sup>.

**Prevention of IAD** is traditionally based on avoiding or minimising exposure to faeces or urine, combined with a structured skin-care regime of gentle cleansing, moisturising and the application of a skin protectant<sup>70-74</sup>.

Performing all of these steps is labour intensive, time consuming and often leads to poor compliance. Barrier Cleansing Cloths incorporates all these traditional steps into one wipe to provide healthcare professionals with a convenient 3-in-one solution.

There is now an increasing amount of clinical evidence showing the importance of a defined skin care regime to both prevent and treat IAD, all studies support the use of a three step approach of gentle cleansing, application of moisturiser and the use of a skin barrier product<sup>70-74</sup>.

**Barrier Cleansing Cloths allow you to implement this skin care regime in one easy step.**

**82%** of nurses report that providing a 3-in-one barrier cloth at the bedside makes it easier to apply a barrier 100% of the time, it makes it easier to facilitate incontinence care and allows them to make more time for other patient care duties<sup>73</sup>.

A complete 3-in-one continence care solution to cleanse, protect and moisturise in one easy cloth.



The use of a one-step wipe containing dimethicone significantly reduces IAD prevalence compared to standard treatment<sup>74</sup>.

### The benefits of Barrier Cleansing Cloths



#### Barrier protection

The incorporated dimethicone barrier protects against prolonged exposure to faeces and urine to allow quicker healing. This reduces sensitive skin handling and friction damage.



#### Moisturising

Added moisturisers, from the cream based formula, help prevent the risk of dry skin by repeatedly washing with soap and water.



#### Hypoallergenic

Dermatologically tested with a skin neutral pH.



#### Cleansing

Mild, soap-free cleansing formula cleans away faeces and urine effectively in one go, reducing the amount of skin handling. The cloths have a gentle scent to help with odours, allowing the patient to feel fresh and comfortable.



#### Soothing

Extracts of camomile help to calm irritated skin and reduce the urge to itch.



#### Natural plant extracts

Extracts of witch hazel have anti-inflammatory properties and promote healthy skin.



#### Long lasting

Barrier function provides long-lasting protection against prolonged exposure to faeces and urine helping to aid skin healing.

“The cloths are great and we get really good patient feedback on them. They are a lot kinder to patients’ skin and staff find them so much easier to use. The whole process is a lot quicker and more dignified.”

Continence Team Lead, Nottingham University Hospitals.

PRODUCT	UNIT OF ISSUE	ORDER CODE
Barrier Cleansing Cloths 8	Pack of 8	CBAR8
Barrier Cleansing Cloths 25	Pack of 25	CBAR25



Everyday- or occasional-use, to prevent the spread of infection.

## Barrier protection

From an effective, disposable trolley protector to the world's first pop-up isolation room Clinell infection barrier products can save time and money compared with conventional solutions, without compromising on effectiveness.

Clinell provides answers to infection risks, promoting cost-efficiency aligned with practicality and safety.



Instant, disposable patient isolation,  
wherever and whenever you need it.

Specifically designed as an alternative to hospitals needing to build permanent, expensive and space-consuming isolation facilities that may only be used occasionally – the Clinell Rediroom enables hospital pathogens and outbreaks to be safely controlled, to reduce the spread of infection.

Designed to assist in isolating infectious patients under contact or droplet precautions.

**COMMON DROPLET PRECAUTION PATHOGENS INCLUDE:**

- Influenza
- Diphtheria
- Mumps
- Pertussis
- Meningococcus

**COMMON CONTACT PRECAUTION PATHOGENS INCLUDE:**

- MRSA
- C. difficile*
- CPE
- Other MDR Gram-negative organisms

Suitable for various temporary isolation settings

**HOSPITAL SETTINGS**

Multi-bed wards, emergency departments, dialysis departments, ambulatory day care units, recovery units, triage areas.

**OTHER EXAMPLES**

Suitable for multiple other facilities, including aged care facilities, outbreak situations, airports and military bases.



Easy to work in:  
Rediroom has similar functional performance to performing patient care in an open plan area<sup>75</sup>.

# CLINELL REDIROOM

Designed to combat the spread of HCAs in healthcare environments, Clinell Rediroom is a cost and time effective method of safe and efficient patient isolation.

## Isolation on demand

A unique solution to combat healthcare-associated infections. Provides effective contact and droplet isolation in a multi-occupancy setting. The easily-deployed canopy is single-use only, further reducing risks of cross-infection.

## Additional single occupancy room

Magnetic door closure, sealed wall to floor and a unique double layered rear wall allowing sealed access to wall services.

## HEPA & carbon filtration

12 Air changes per hour filters air as well as providing temperature control and odour elimination.

## Hands-free door opening mechanism

Reduces risk of hand contamination during entry and exit.

## Built in PPE station

Alcohol hand rub and PPE placed at point of use to promote compliance.

## Light weight, durable and easy to move

Create a single room on demand. Easily deployed by one person in less than 5 minutes.

## Conforms to infection prevention guidelines

Conforms with multinational guidelines including the Australia<sup>76</sup> and UK<sup>77</sup>.

deployed in less than 5 minutes

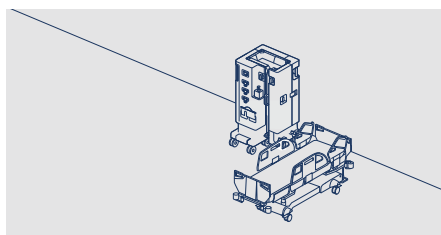

**1.** Position cart and load canopy

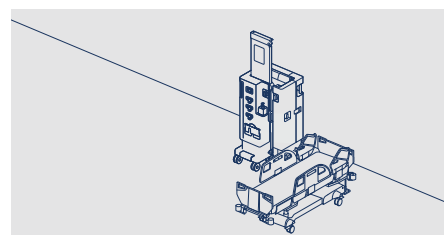

**2.** Raise frame, canopy deploys automatically

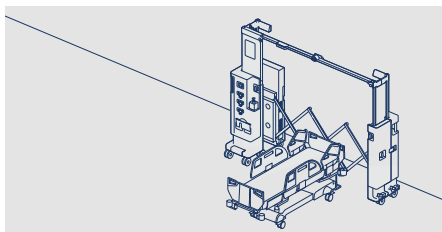

**3.** Extend behind bed and over patient

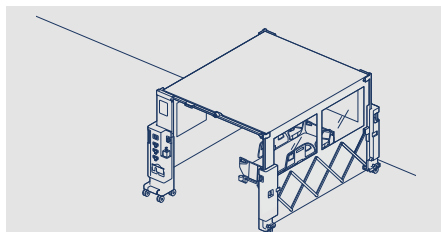

**4.** Fix tape to floor and filter unit

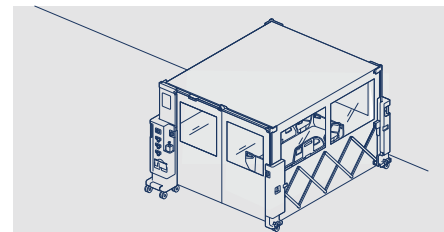

**5.** Fold out curtains and attach to runners

PRODUCT	UNIT OF ISSUE	ORDER CODE
Rediroom frame	Single unit	REDI1
Rediroom canopy	Box of 3	REDICAN1

# TROLLEY PROTECTOR

100% fluid and microorganism resistant barrier leaving trolleys ready to use almost immediately\*



Clinell Trolley Protector acts as an effective barrier, preventing microorganisms and bodily fluids\* from passing through to the patient trolley.

## Saves time and money

Reduces the time staff spend cleaning trolleys and money spent on cleaning products.

## Reduces patient turnaround time

Ensures trolleys are clean and ready to use almost immediately. The single use protector is quick and easy to use and dispose of.

## Proven 100% effective barrier by an accredited lab\*

Made with a unique 100% fluid and microorganism resistant material, as demonstrated by studies conducted at an independent UKAS accredited test lab.

## Prevents gross contamination and prolongs mattress life

Prevents heavy soiling from bodily fluids, making trolleys and mattresses last longer and reducing replacement costs.

## Developed with infection prevention professionals

Collaboratively designed with IPC nurses to solve a real issue.

### APPLICATION:



Roll out the protector onto patient trolley.

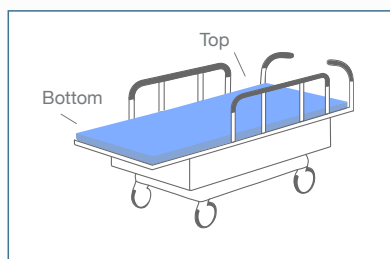

Spread out the protector from top to bottom.

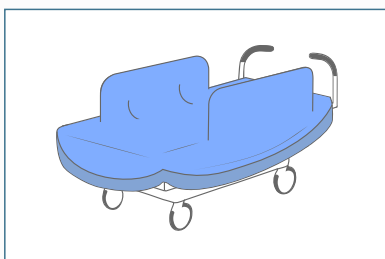

Pull the side of the protector over the bed rails with elasticated bottom edges folded up.

### REMOVAL:

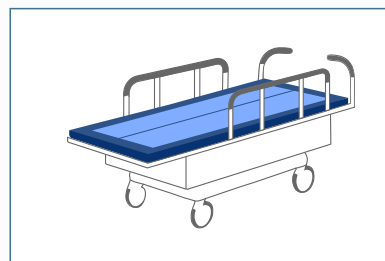

Detach protector from bed rails and sides folding protector in the middle.



Re-roll from top to bottom to keep spills contained.

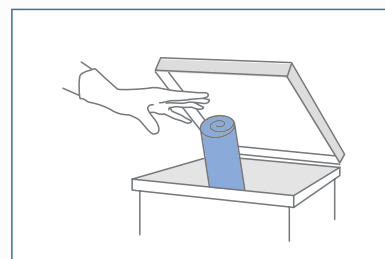

Dispose of as per your local policy.

### PRODUCT

Trolley Protector

### UNIT OF ISSUE

Box of 6

### ORDER CODE

CTPR6

\*Refer to our website [www.clinell.com](http://www.clinell.com) to read more about the studies conducted by SMTL.

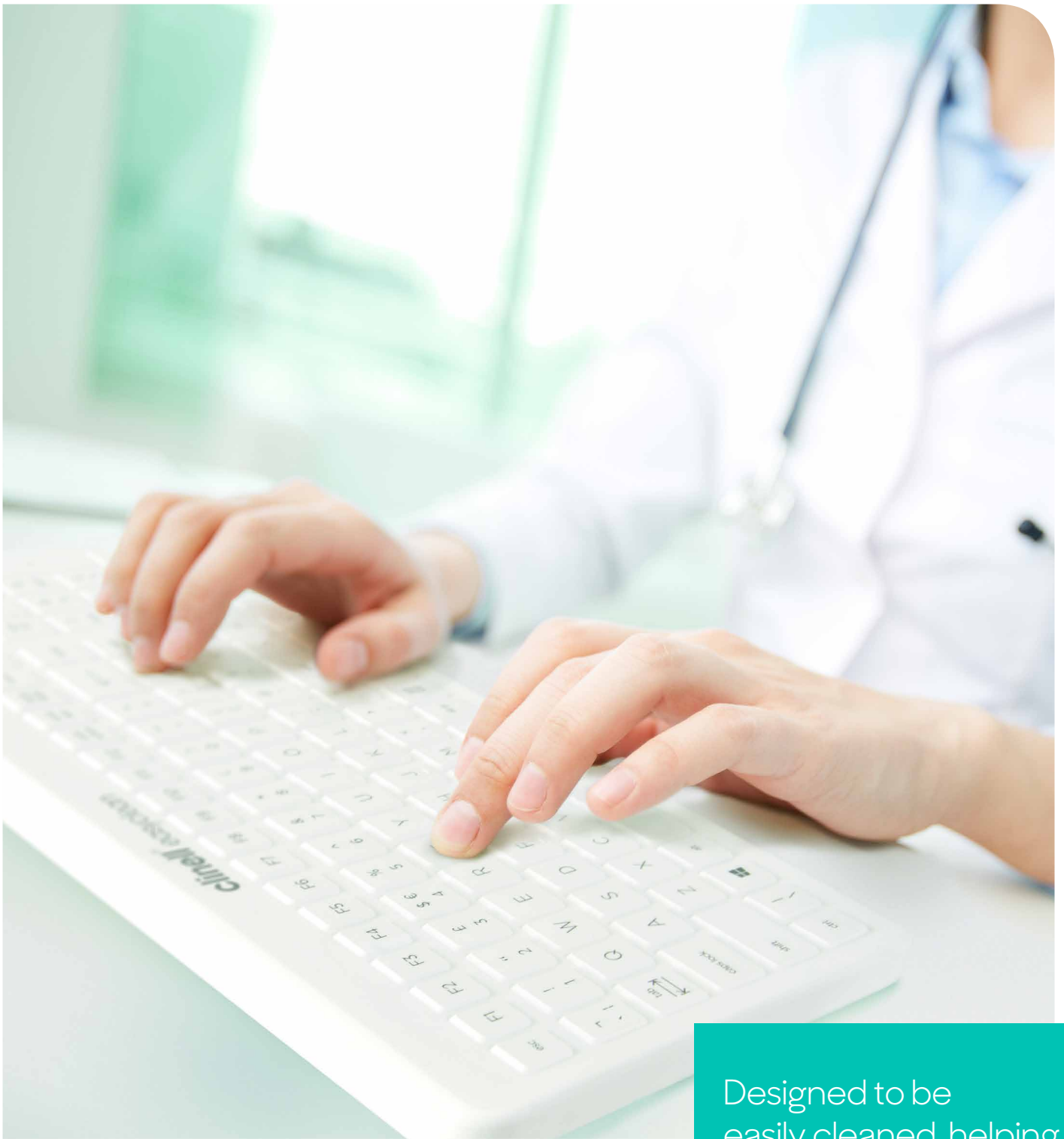

Designed to be easily cleaned, helping reduce HCAs.

# clinnell<sup>®</sup> easyclean

GAMA Healthcare aim to provide the healthcare sector with a complete infection prevention solution. Working with the UK's leading infection control specialists, we redesign hard to clean items for effortless decontamination.

# EASYSILEAN COMPUTER ACCESSORIES

Keyboards have been shown to serve as reservoirs of nosocomial pathogens and vectors for cross transmission in the ICU setting<sup>78</sup>.



## Washable Keyboard

Studies have shown 33-95% of keyboards have positive cultures for microbes including MDROs<sup>6,79,80,81</sup>. The degree of contamination observed is high enough to potentially allow transmission via contaminated hands<sup>6,82</sup>.

Guidelines recommend hospitals have washable keyboards or keyboard covers in areas accessed by patients and that keyboards and mice should be disinfected daily and when visibly soiled, with a hospital-grade disinfectant cleaner<sup>79,80</sup>.

Clinell EasyClean computer accessories were developed to simplify cleaning procedures and increase compliance. They are available in wipeable silicone and conventional true type. Both are 100% waterproof, dishwasher safe and can even be disinfected with chlorine.

## Dishwasher safe\*

For quick, easy and effective cleaning. An integrated USB cap protects the connector.

## Compatible with all hospital disinfectants

Proven to withstand regular disinfection procedure, even with chlorine.

## Natural look and feel

Our keyboards look and feel like conventional keyboards, unlike many other wipeable keyboards aimed at the healthcare sector.

## 100% waterproof\*

All products are fully submersible and manufactured to meet the rigorous IP68 specifications.

## Laser etched keys

For long lasting legibility and durability.

## Easy clean silicone†

Easy clean wipeable surface - not a single hole or crevice for dirt to accumulate in.

## Power off

Convenient keyboard power off button to allow cleaning whilst plugged in.

## Backlit keyboard‡

Our silicone keyboards are backlit to improve legibility.

## Laser guided precision§

Laser technology for a more accurate and responsive mouse.

## Silent Use‡

Traditional keyboards can be very noisy to type on. Our silicone keyboards have the advantage of silent key strokes.

\* Not applicable to Smartcard Readers (CSMS1W/CSMS1B).

† Not applicable to True Type Keyboard (CKTT1).

‡ Silicone Keyboards only (CKS1W/CKS1B).

§ Silicone Mice only (CMS1W/CMS1B).

PRODUCT INFORMATION	UNIT OF ISSUE	ORDER CODE
True Type Keyboard (black)	Single unit	CKTT1
Silicone Keyboard (black)	Single unit	CKS1B
Silicone Keyboard (white)	Single unit	CKS1W
Silicone Mouse (black)	Single unit	CMS1B
Silicone Mouse (white)	Single unit	CMS1W
Silicone Smartcard reader (black)	Single unit	CSMS1B
Silicone Smartcard reader (white)	Single unit	CSMS1W











Awarded the highest waterproof rating, IP68



## Silicone Keyboard

The low profile keys and single piece construction makes them ideal for frequent wiping. Manufactured from treated, antimicrobial silicone, they are 100% waterproof and dishwasher safe. The blue backlit keyboards are available in black and white.

-  100% waterproof
-  Laser etched keys
-  Made from silicone
-  No nooks or crannies
-  Dishwasher safe
-  Wipeable
-  Backlit keyboard
-  USB plug-and-play
-  Protective USB cap



## TrueType Keyboard





A waterproof keyboard that looks and feels like a conventional keyboard. The laser etched keys ensure long lasting legibility whilst the durable, antimicrobial plastic provides further protection. They are 100% spill proof, waterproof and dishwasher safe.

-  100% waterproof
-  Laser etched keys
-  Dishwasher safe
-  Wipeable
-  USB plug-and-play
-  Natural look and feel
-  Protective USB cap



## Silicone Mouse

Manufactured from a single piece of high quality, antimicrobially treated silicone, the mouse is perfect for frequent wiping. Benefitting from laser guided precision and a touch strip to enable easy scrolling, the mouse is 100% spill proof, waterproof and dishwasher safe.

-  100% waterproof
-  Laser guided precision
-  Made from silicone
-  No nooks or crannies
-  Dishwasher safe
-  Wipeable
-  USB Plug-and-play
-  Protective USB cap

Studies have shown that 1 in 4 keyboards in acute district general hospitals are contaminated with MRSA<sup>82</sup> and that hand hygiene rarely accompanies keyboard contact<sup>6</sup>.

# EASYCLEAN COMMUNE

**GOOD  
DESIGN**

Unique, award-winning, super-hygienic, multi-functional commode. It can be fully dismantled, making it simple and easy to clean.



## Award winning

Winner of the GOOD DESIGN™ award 2012 - organised by The Chicago Athenaeum Museum of Architecture and Design.

## Multi-functional

Suitable for both pulp and plastic bedpans. Can also be used as a shower chair or over a toilet.

## Removable single piece, plastic bedpan rack

The fully removable rack allows for easy cleaning, over the toilet access and the insertion of top-loading pulp bedpans.

## Durable, stainless steel frame

3 year frame warranty.

## Easy move lockable wheels

With EasyMove™ and TotalStop™ design.

## Convenient seat storage

The seat cover can be neatly stored at the back of the commode.

## Non-stain plastic

Resistant to staining and chemical damage.

## Easy clean

No screws, nuts or bolts and smooth, curved, non-porous surfaces allow for better and easier cleaning which increases compliance. This means less places for dirt and germs to accumulate.

## Rotating, removable footrests

Footrests that rotate 360° so they can be turned out of the way for easy mounting or dismounting. Incorporates patented Clip & Slide mechanism for easy removal†.

## Safe and sanitary plastic seat

Latex-free seat cover, which sits flat within the seat, with no stitching or foam which guards against germ build up, allergies and is easy to clean.

## Hinged arm rests

Enables easy patient transferring/support handling. The arms lock securely when down.

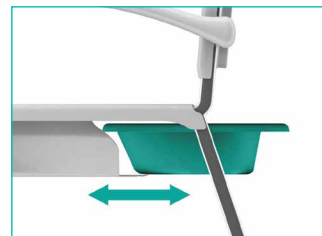

Plastic or pulp bed pans slide in from the rear.



Top loading, moulded, single piece, plastic bedpan rack.



Hinged, lockable arms for easy patient transfer.



Seat cover stowed safely at the back of the seat.

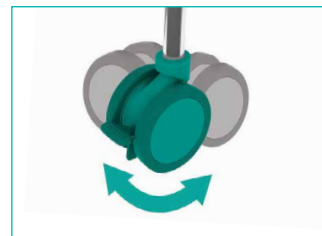

Patented EasyMove™ and TotalStop™ design wheels.



Patented clip and slide footrests.

† Detachable Footrest: UK GB2496861B

PRODUCT	UNIT OF ISSUE	ORDER CODE
EasyClean Commode	Single unit	CCOM1

**Only 10 pieces**  
easy assembly, durable,  
stainless steel frame -  
no screws, nuts or bolts



Easily show the  
cleanliness of  
equipment

## Support products

Ensuring you get the best out of your GAMA products, our support range provides clever solutions to increase cleaning compliance.

Our indicator products provide instant visual cues, letting you know if equipment is decontaminated and safe for patient use.

# INDICATOR NOTES

Indicator Notes to fill out and attach prior to, or after, disinfection, to show that the equipment has been or needs to be sanitised.



## Simple and quick

It's easy to see that objects and equipment have been cleaned. By filling in the note/tape, the person responsible is able to leave a clear record.

## Specifically developed

The Clinell Clean Indicator Notes were developed in conjunction with Guy's & St. Thomas' NHS Foundation Trust Infection Control Department.

## Three variations

Clinell Clean Indicators are conveniently available on a roll or in red and green note format – all of which are adhesive.

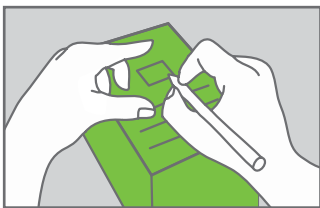

Clearly tick the 'I am clean/I need to be cleaned' box and write your name, the time and the date in the area provided.

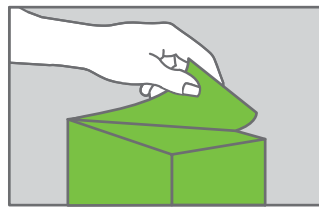

Peel the completed note off the pad.



Stick the note to the object or equipment in an easily visible place.

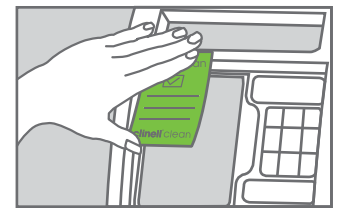

Firmly press/rub the top area of the note to ensure it is properly attached to the object.

## 'I need to be cleaned'

It is not always possible to clean equipment immediately after use and this means that there is a risk of items not being decontaminated between patients. Clinell Clean Red Indicator Notes provide a visible sign that an item must be cleaned before re-use.

## 'I am clean'

After local decontamination has taken place; signed and dated Clinell Clean Green Indicator Notes provide a visible assurance that an item is ready for re-use with another patient.

## Stick your pads where you need them

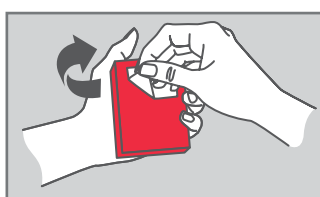

Peel off the backing sticker from the reverse of the pack.



Select a clean, dry, accessible wall/surface and firmly press the pad onto it for 10 seconds.

Supplied in boxes of 1,000 notes, each containing four pads of 250 notes. Available in both red and green, each pad has a no-residue adhesive back for attaching to equipment and walls.

# INDICATOR TAPE

Indicator Tape (self adhesive) to show that equipment has been sanitised. It provides the easiest method of illustrating completed disinfection procedures.



## Increased compliance

Clinell Clean Indicators were developed for labelling after cleaning, recommended by the Saving Lives Guidelines<sup>83</sup>.

## New design

This single use tape cannot be used twice so there is no risk of transference.

## No damage to surfaces

The tape will only adhere to itself (back to back) and no other surface.



Select a suitable length of tape from the dispenser and tear through the roll so that you have a strip of indicators.

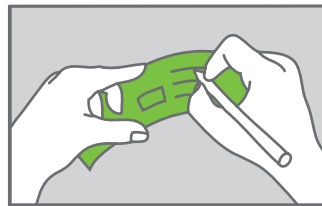

Clearly tick the 'I am clean' box and write your name, the time and the date in the area provided.

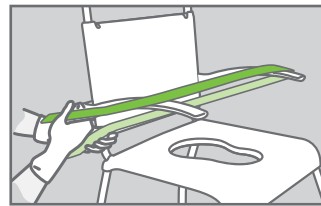

Press the two sides of the tape together and rub to bind the sticky underside.

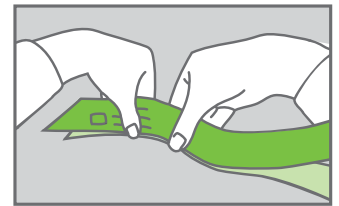

To join the ends, firmly press the two sides of the tape back to back.

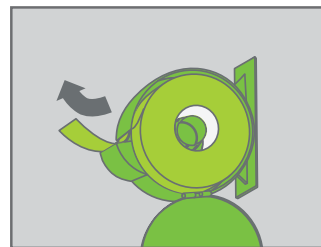
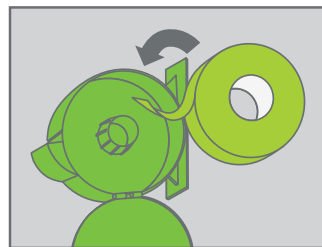
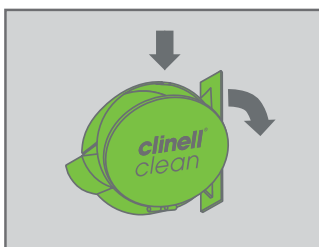

## Helping you conform to UK NHS Saving Lives Initiative 'High Impact Interventions No.8'<sup>83</sup>

PRODUCT	UNIT OF ISSUE	ORDER CODE
Indicator Notes Red	4 x 250 notes	CCIN1000R
Indicator Notes Green	4 x 250 notes	CCIN1000G
Indicator Tape	Single unit	CCIT100
Indicator Tape Dispenser*	(for CCIT100)	CCIT100D



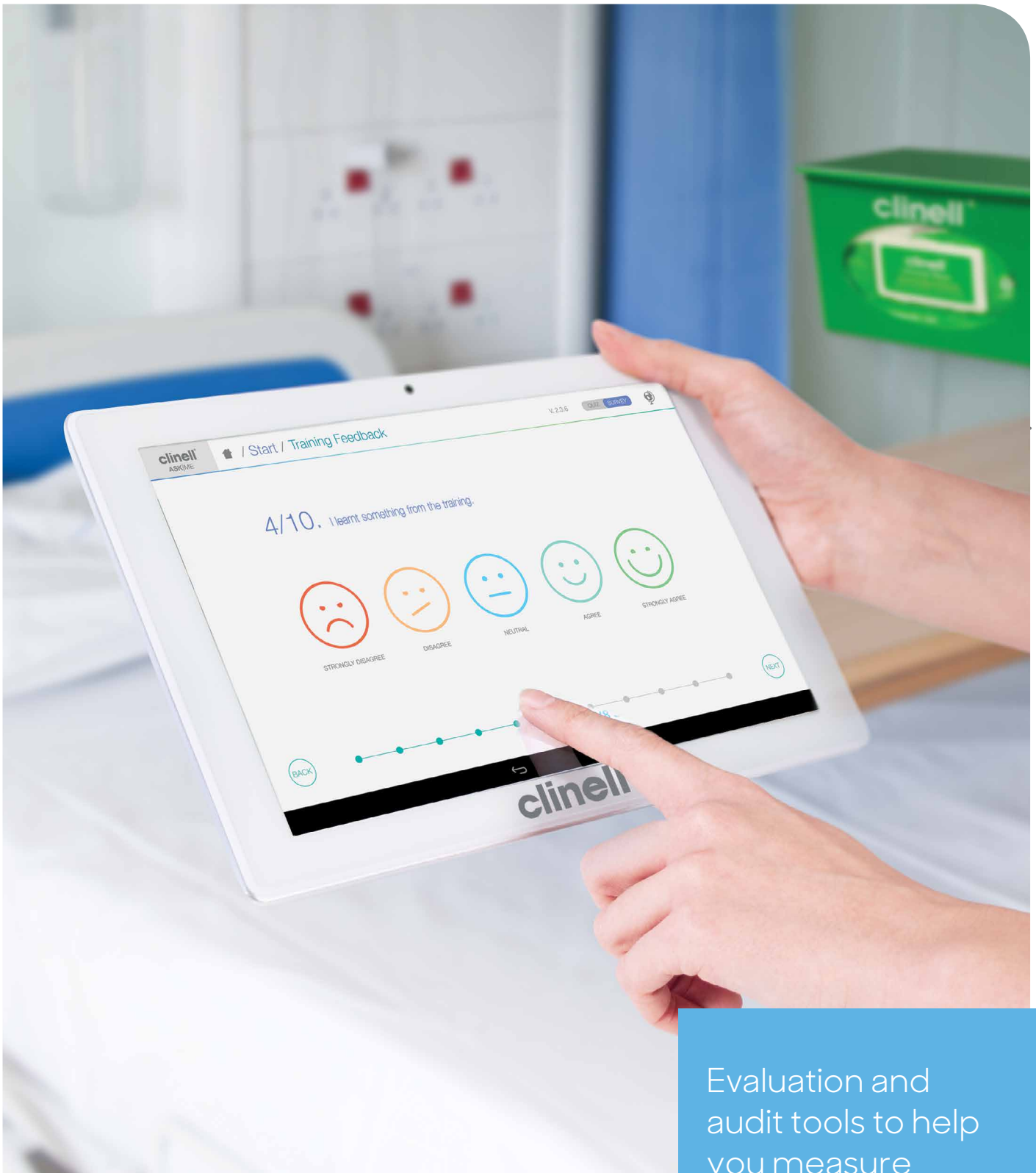

Evaluation and audit tools to help you measure success, easily.

## Implementation & training

GAMA Healthcare tablet-based applications are designed to suit the needs of the user, they are customisable, easy to use and practical. The apps can help ensure compliance and improvement, gather feedback or help generate bespoke reports. AskMe and EvaluClean also have the capability for data sharing for a wider overview of results. Apps are usually supplied as part of the award-winning Clinell Training Package.

# training package



The most accessible, fun and comprehensive educational guide to environmental cleaning ever compiled for healthcare professionals.



GAMA Healthcare are committed to providing market leading aftercare support: we work closely with you to ensure that we provide the best training solution for your hospital. Our award winning Training Package aims to be the most comprehensive and useful tool for healthcare professionals available.

## Specialist development

Clinell's Training Package has been developed in conjunction with some of the leading Infection Prevention Specialists in the UK.

## Customisable content

Full of new content, you can now build and customise every part of your training session, tailoring it to specific needs, target audiences and time frames. You can create bespoke sessions based on your hospital's current issues. If there is an outbreak, a quick refresher course can make all the difference.

## Educational games

Specially developed group games and videos make learning interactive and engaging whilst teaching the importance and best practice of environmental cleaning.

## Measuring development

Also included is our unique survey app which can measure knowledge before and after training, giving healthcare providers valuable feedback on how training is progressing.

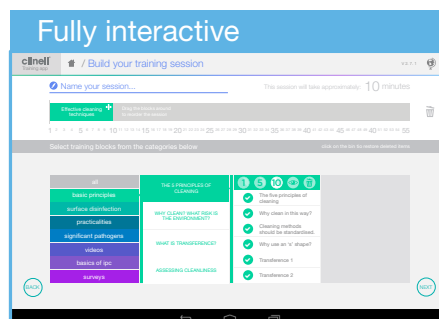

Trainers can choose how to give training, perfect for group sessions as well as one-on-one tutorials. Every session is completely customisable. The user can choose the amount of detail/skill required, the length of training, the videos to include, the order of each section and much more.



Videos that clearly illustrate the best cleaning practices to reduce microorganisms on key items often found in healthcare settings. Cleaning with different products and cleaning different hospital equipment are included.

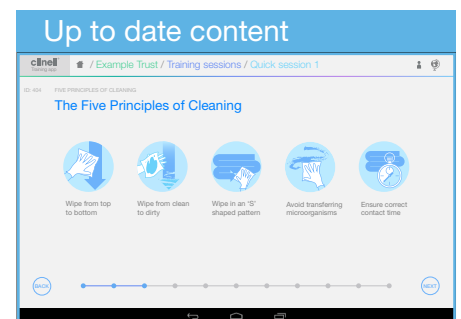

Based on the newest scientific evidence and practices, there are sections on best practices, pathogens, products, surface disinfection and more. Complete with an up-to-date, 50 page supporting evidence document.

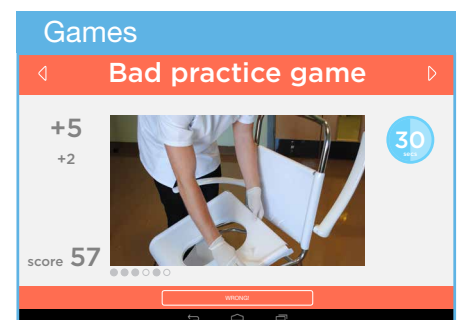

Fun and engaging games help to emphasise key learning points. These include games of speed, judgement and choice, which is a great way to increase knowledge on best practices.

PRODUCT	UNIT OF ISSUE	ORDER CODE
Clinell Training Package (with EvaluClean)	Single unit	CTP1

# evaluclean™

The most advanced system available to evaluate environmental cleanliness. Comprising of fluorescent markers, UV torch and tablet-based audit software.



Fluorescent marker is a better tool than ATP in determining how thoroughly a surface is wiped and mimics the microbiological data better than ATP<sup>84</sup>.

## Fluorescent marker pens & UV Torch

Our fluorescent gel has been rigorously tested to ensure it remains wipeable from all non-porous hospital surfaces. The ultra-strong 28-LED UV torch provides excellent mark visibility.

## Customisable

The unique Clinell Evaluclean software system, delivered on a tablet, is completely customisable. Select the equipment and surfaces you wish to monitor from the existing database, or add new ones with the tablet camera. Choose whether to audit the room or specific items.

## Assess

Use the fluorescent pens to mark equipment and surfaces and then record their location with the touch of a screen. Set reminders when to check the mark and use the torch to assess whether the invisible fluorescent gel has been cleaned away. Quickly and easily use the app to record the efficiency of the cleaning.

## Instant access

Sync and collate audit data across multiple devices and create organisation wide reports anywhere, through the online portal.

The use of a fluorescent marker system in ICU resulted in 40% more surfaces being cleaned<sup>85</sup>.

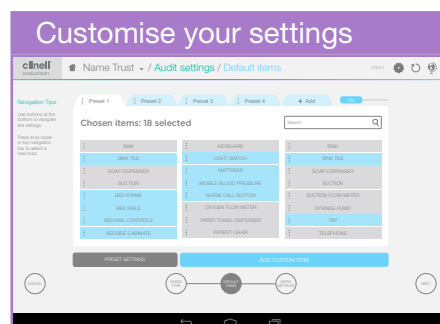

Choose which equipment you wish to monitor from the extensive list of pre-loaded items, or add your own items.

Specify the 'type of clean' and whether to audit a specific room or item. Select a length of time before you are reminded to check the area or choose immediately.

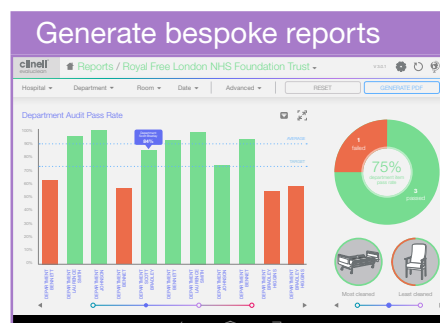

View live reports, analyse by hospital, department, room type or item. Instantly monitor trends, compare performance and generate bespoke, attractive and easy to understand reports.

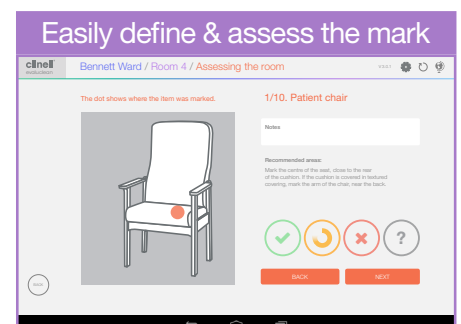

Tap the illustration where you have marked the item. If the item isn't in our database, simply take a photo and mark the image. After cleaning, shine the UV torch onto the area highlighted on the illustration. If the mark has gone, the item has been effectively cleaned, if not more training may be required.

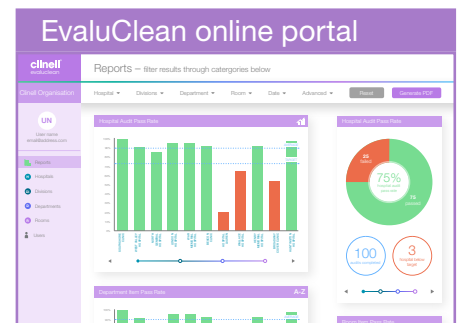

Securely view data online from multiple tablets and hospitals throughout an organisation with Clinell's new Evaluclean web server.

PRODUCT	UNIT OF ISSUE	ORDER CODE
Clinell Evaluclean Kit	Single unit	CUV1
Clinell Evaluclean Fluorescent Pen	Box of 6 Pens	CUVP6

# commode audit app

A specifically designed commode audit app which provides data collection, analysis and instant reporting functions in a portable, paperless format.

## How does it work?

Data is entered into an easy to follow Android app specifically designed for mobile data collection. Details of each commode are entered, including cleanliness, condition of the commode and specific issues relating to individual components. This data is then used to create bespoke reports that can be centred on the organisation or unit and for each commode type within the organisation.

## How will this improve cleanliness?

The use of data generated in the app can be used to focus improvement strategies on issues identified from the data, be they mechanical issues or cleanliness standards. Repeat audits can be used to demonstrate the effect of interventions and to track trends over time. Feedback of data can also be used to motivate staff.

## How can I get this for my team?

This app is delivered on the latest 10" Android tablet software. The tablet, along with its applications, is provided free of charge to Clinell customers.\* Simply call your local Clinell sales representative to organise the implementation into your organisation.

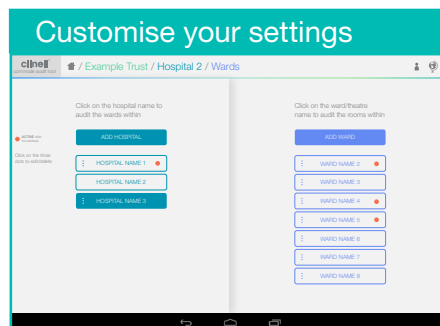

Select or type the name of your hospital/organisation along with the specific wards.

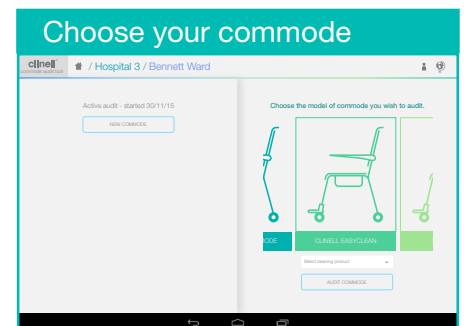

Choose the commode model or take a photo of the commode you wish to audit. You can identify the commode with its serial number by renaming it.

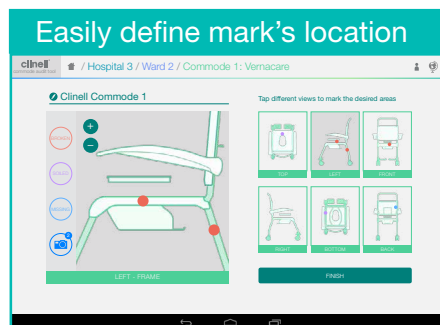

Inspect each element of the commode for soiling and damage. The app shows the commode from six different angles. Record areas that are broken, soiled or missing on the corresponding commode part directly on the app. Take photos to evidence dirty or broken areas.

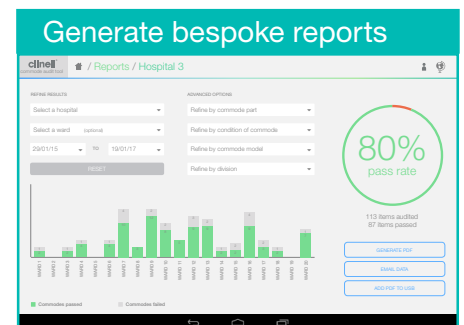

Instantly monitor hospital wide trends, compare performance against set benchmarks and generate bespoke, attractive and easy to understand reports. See a detailed report for each commode, showing you the different models within your organisation and the replacement parts required to restore them.

\* Subject to annual spend.

# ask|me survey app

Evaluation measures are vital for examining the contribution of professional training to organisational success in a reliable manner; to ensure that the training method meets the training needs of the learners<sup>86</sup>.

## Instant Access

The unique AskMe software system, delivered on a tablet, comes pre-loaded with ready to use default surveys to allow you to collect feedback as quickly and easily as possible.

## Customisable

AskMe is totally customisable. You can create your own bespoke surveys, edit existing survey templates and save these for further use. The most straightforward and versatile option is the use of smiley icons, which allow you to quickly and simply gauge user feedback about your survey questions. Advanced features can also be utilised by choosing from a range of selectable options. This allows the user to select from multiple answers, rank questions, use a sliding scale or use a free type option. These advanced features provide more qualitative results from your surveys.

## Reports

AskMe has a PDF viewer which enables you to create and view reports immediately by session, trainer or location. You can also email these reports directly from the tablet. An additional feature generates CSV files so that advanced users can perform their own analytics.

## Feedback

AskMe provides a complete solution for real time feedback, allowing you to collect and analyse staff feedback and knowledge in a survey format.

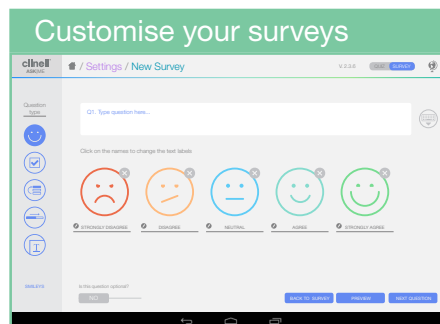

Choose between a variety of questions types such as smilies, multiple choice, ranking, scaling and free type. Your choice of advanced feature will depend on the questions you wish to ask and the type of response you wish to receive.

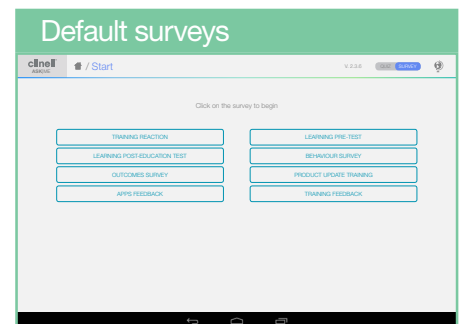

Default surveys are already loaded into the AskMe software. It's quick and easy to get feedback and thoughts on a variety of subjects.

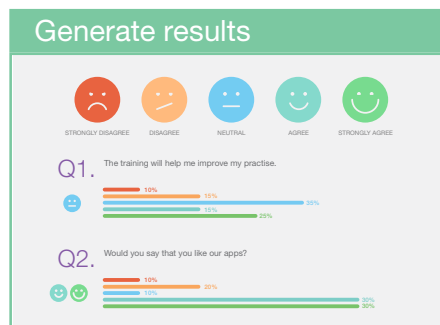

Results and feedback can be generated instantly from the tablet and shared via email or USB.

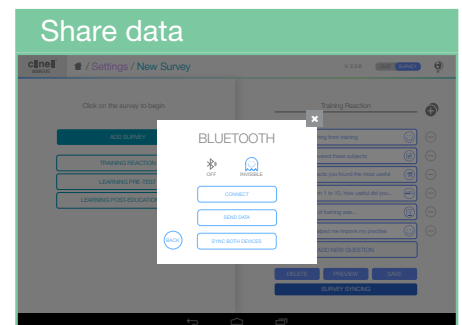

Data from surveys can be shared between devices easily via Bluetooth. This allows you to collate data for a wider overview of your results.

# REFERENCES

1. Health Protection Agency. English National Point Prevalence Survey on Healthcare-associated Infections and Antimicrobial Use, 2011: Preliminary data. Health Protection Agency, London; 2012.
2. Health Protection England. Healthcare associated infections (HAI): point prevalence study, England 2016 [updated 2016]. Available from: <https://www.gov.uk/government/publications/healthcare-associated-infections-hcai-point-prevalence-survey-england>.
3. Dancer SJ, White LF, Lamb J, Girvan EK, Robertson C. Measuring the effect of enhanced cleaning in a UK hospital: a prospective cross-over study. *BMC Med*. 2009;7:28.
4. Dancer SJ. The role of environmental cleaning in the control of hospital-acquired infection. *Journal of Hospital Infection*. 2009;73(4):378-85.
5. Rutala WA, Weber DJ. Role of the hospital environment in disease transmission, with a focus on *Clostridium difficile*. *Healthcare Infection*. 2013;18(1):14.
6. Wilson AP, Hayman S, Folan P, Ostro PT, Birkett A, Batson S, et al. Computer keyboards and the spread of MRSA. *J Hosp Infect*. 2006;62(3):390-2.
7. Weber DJ, Anderson DJ, Sexton DJ, Rutala WA. Role of the environment in the transmission of *Clostridium difficile* in health care facilities. *Am J Infect Control*. 2013;41(5 Suppl):S105-10.
8. Weber DJ, Rutala WA, Miller MB, Huslage K, Sickbert-Bennett E. Role of hospital surfaces in the transmission of emerging health care-associated pathogens: norovirus, *Clostridium difficile*, and Acinetobacter species. *Am J Infect Control*. 2010;38(5 Suppl 1):S25-33.
9. Voss A, Meis JF. Hand hygiene and health-care-associated infections. *Lancet Infect Dis*. 2007;7(5):304-5; author reply 5-6.
10. Istenes N, Bingham J, Hazlett S, Fleming E, Kirk J. Patients' potential role in the transmission of health care-associated infections: prevalence of contamination with bacterial pathogens and patient attitudes toward hand hygiene. *Am J Infect Control*. 2013;41(9):793-8.
11. Weber DJ, Anderson D, Rutala WA. The role of the surface environment in healthcare-associated infections. *Curr Opin Infect Dis*. 2013;26(4):338-44.
12. Sanderson PJ, Weissler S. Recovery of coliforms from the hands of nurses and patients: activities leading to contamination. *J Hosp Infect*. 1992;21(2):85-93.
13. Dancer SJ. Importance of the environment in methicillin-resistant *Staphylococcus aureus* acquisition: the case for hospital cleaning. *Lancet Infect Dis*. 2008;8:101-13.
14. Barker J, Vipond IB, Bloomfield SF. Effects of cleaning and disinfection in reducing the spread of Norovirus contamination via environmental surfaces. *J Hosp Infect*. 2004;58(1):42-9.
15. Roberts K, Smith CF, Snelling AM, Kerr KG, Banfield KR, Sleight PA, et al. Aerial dissemination of *Clostridium difficile* spores. *BMC Infectious Diseases*. 2008;8:7.
16. Smith SJ, Young V, Robertson C, Dancer SJ. Where do hands go? An audit of sequential hand-touch events on a hospital ward. *The Journal of hospital infection*. 2012;80(3):206-11.
17. Kramer A, Schwebke I, Kampf G. How long do nosocomial pathogens persist on inanimate surfaces? A systematic review. *BMC Infect Dis*. 2006;6:100.
18. Kim KH, Fekety R, Batts DH, Brown D, Cudmore M, Silva J, Jr., et al. Isolation of *Clostridium difficile* from the environment and contacts of patients with antibiotic-associated colitis. *J Infect Dis*. 1981;143(1):42-50.
19. Otter JA, Yezli S, Salkeld JA, French GL. Evidence that contaminated surfaces contribute to the transmission of hospital pathogens and an overview of strategies to address contaminated surfaces in hospital settings. *Am J Infect Control*. 2013;41(5 Suppl):S6-11.
20. Morter S, Bennet G, Fish J, Richards J, Allen DJ, Nawaz S, et al. Norovirus in the hospital setting: virus introduction and spread within the hospital environment. *Journal of Hospital Infection*. 2010.
21. Bloss R, Meyer S, Kampf G. Adsorption of active ingredients of surface disinfectants depends on the type of fabric used for surface treatment. *J Hosp Infect*. 2010;75(1):56-61.
22. Engelbrecht K, Ambrose D, Sifuentes L, Gerba C, Weart I, Koenig D. Decreased activity of commercially available disinfectants containing quaternary ammonium compounds when exposed to cotton towels. *Am J Infect Control*. 2013;41(10):908-11.
23. Hoyle GW, Svendsen ER. Persistent effects of chlorine inhalation on respiratory health. *Ann N Y Acad Sci*. 2016;1378(1):33-40.
24. Bloss R, Meyer S, Kampf G. Adsorption of active ingredients of surface disinfectants depends on the type of fabric used for surface treatment. *J Hosp Infect*. 2010;75(1):56-61.
25. Sifuentes LY, Gerba CP, Weart I, Engelbrecht K, Koenig DW. Microbial contamination of hospital reusable cleaning towels. *Am J Infect Control*. 2013;41(10):912-5.
26. Humphreys PN, Finan P, Rout S, Hewitt J, Thistlethwaite P, Barnes S, et al. A systematic evaluation of a peracetic-acid-based high performance disinfectant. *Journal of Infection Prevention*. 2013;14(4):126-31.
27. Goldsmith M, Latief M, Friedl J, Stuart L. Adsorption of available chlorine and quaternary by cotton and wool fabrics from disinfecting solutions. *Applied microbiology*. 1954;2(6):360.
28. Bloomfield SF. Significance of biocide usage and antimicrobial resistance in domiciliary environments. *Journal of Applied Microbiology*. 2002;92(s1).
29. Mimoz O, Lucet JC, Kerforne T, Pascal J, Souweine B, Goudet V, et al. Chlorhexidine-alcohol versus povidone iodine/alcohol antiseptics for catheter-related infection prevention: an open-label, multicentre, randomised controlled trial. *Intensive Care Med Exp*. 2015;3 (Suppl 1):A409.
30. Chaiyakunapruk N, Veenstra DL, Lipsky BA, Saint S. Chlorhexidine compared with povidone-iodine solution for vascular catheter-site care: a meta-analysis. *Annals of internal medicine*. 2002;136(11):792-801.
31. Pichler J, Soothill J, Hill S. Reduction of blood stream infections in children following a change to chlorhexidine disinfection of parenteral nutrition catheter connectors. *Clin Nutr*. 2014;33(1):85-9.
32. Soothill JS, Bravery K, Ho A, Macqueen S, Collins J, Lock P, A fall in bloodstream infections followed a change to 2% chlorhexidine in 70% isopropanol for catheter connection antiseptics: a pediatric single center before/after study on a haemopoietic stem cell transplant ward. *Am J Infect Control*. 2009;37(8):626-30.
33. Kaler W, Chinn R. Successful Disinfection of Needleless Access Ports: A Matter of Time and Friction. *Journal of the Association for Vascular Access*. 2007;12(3):140-2.
34. Loveday HP, Wilson JA, Pratt RJ, Golsorkhi M, Tingle A, Bak A, et al. epic3: national evidence-based guidelines for preventing healthcare-associated infections in NHS hospitals in England. *J Hosp Infect*. 2014;86 Suppl 1:S1-70.
35. National Institute of Clinical Excellence. Clinical Guideline 2. Infection: prevention and control of healthcare-associated infections in primary and community care. 2012.
36. Department of Health. High Impact Interventions: Central venous catheter care bundle; 2011. Available from: <http://webarchive.nationalarchives.gov.uk/20120118164404/hcai.dh.gov.uk/whatooido/high-impact-interventions/>.
37. Boyce JM, Pittet D. Guideline for Hand Hygiene in Health-Care Settings. Recommendations of the Healthcare Infection Control Practices Advisory Committee and the HIPAC/SHEA/APIC/IDSA Hand Hygiene Task Force. *Am J Infect Control*. 2002;30(8):S1-46.
38. Pratt RJ, Pellowes CM, Wilson JA, Loveday HP, Harper PJ, Jones SR, et al. epic2: National evidence-based guidelines for preventing healthcare-associated infections in NHS hospitals in England. *J Hosp Infect*. 2007;65 Suppl 1:S1-64.
39. Laboratory HIR. Sporidical Efficacy Test. Available from: <http://clinell.com/wp-content/uploads/pdf/Clinell%20Sporidical%20-%20%20%20%20Test.pdf>. 2007.
40. Otter JA et al. Surface-attached cells, biofilms and biocide susceptibility: implications for hospital cleaning and disinfection. *J Hosp Infect*. 2015;89(1):16-27.
41. Donlan RM, Costerton JW. Biofilms: Survival Mechanisms of Clinically Relevant Microorganisms. *Clin Microbiol Rev*. 2002;15(2):167-93.
42. Vickery K et al. Presence of biofilm containing viable multiresistant organisms despite terminal cleaning on clinical surfaces in an intensive care unit. *J Hosp Infect*. 2012;80(1):52-55.
43. Cardiff University. Transfer and Regrowth Test for the Evaluation of Anti-biofilm activity of Clinell Sporidical Wipe. 2018. Full report can be found at [clinell.com](http://clinell.com).
44. Siani H, Cooper O, Maillard JY. Efficacy of "sporidical" wipes against *Clostridium difficile*. *Am J Infect Control*. 2011;39(3):212-8.
45. Carter Y, Barry D. Tackling C. difficile with environmental cleaning. *Nurs Times*. 2011;107(36):22-5.
46. Ali S, Moore G & Wilson APR. Spread and persistence of *Clostridium difficile* spores during and after cleaning with sporidical disinfectants. *Journal of Hospital Infection*; 97-98, 2011.
47. Goldenberg SD, Patel A, Tucker D & French GL. Lack of enhanced effect of a chlorine dioxide-based cleaning regimen on environmental contamination with *Clostridium difficile* spores. *Journal of Hospital Infection*; 62-67, 2012.
48. McDonnell G & Russell AD. Antiseptics and Disinfectants: Activity, Action, and Resistance. *Clin. Microbiol. Rev.*; 12: 147-179, 1999.
49. Maillard JY. Innate resistance to sporicides and potential failure to decontaminate. *Journal of Hospital Infection*; 77: 204-209, 2011.
50. Mahida N, Boswell T. Non-slip socks: A potential reservoir for transmitting multidrug resistant organisms in hospitals? *Journal of Hospital Infection*. 2016.
51. Galvin J, Almatroudi A, Vickery K, Deva A, Lopes LK, Costa DM, et al. Patient shoe covers: Transferring bacteria from the floor onto surgical bed sheets. *Am J Infect Control*. 2016.
52. Koganti S, Alhmidhi H, Tomas ME, Cadnum JL, Jenson A, Donskey CJ. Evaluation of Hospital Floors as a Potential Source of Pathogen Dissemination Using a Nonpathogenic Virus as a Surrogate Marker. *Infect Control Hosp Epidemiol*. 2016;1-4.
53. Otter JA, Yezli S, French GL. The Role Played by Contaminated Surfaces in the Transmission of Nosocomial Pathogens. *Infect Control Hosp Epidemiol*. 2011.
54. Mitchell BG, Dancer SJ, Anderson M, Dehn E. Risk of organism acquisition from prior room occupants: A systematic review and meta analysis. *J Hosp Infect*. 2015.
55. Ledwoch K, Moggaa M, Pascoe M, Maillard J-Y. Dry surface biofilms: a new challenge for disinfection. *American Society for Microbiology*, San Francisco, United States; 2019.
56. Humphreys PN, Finan P, Rout S, et al. A systematic evaluation of a peracetic-acid-based high performance disinfectant. *J Infect Prev*. 2013.
57. Aranega-Bou P, George RP, Verlander NQ, et al. Carbapenem-resistant Enterobacteriaceae dispersal from sinks is linked to drain position and drainage rates in a laboratory model system. *J Hosp Infect*. 2019.
58. Kotay S, Chai W, Guilford W, Barry K, Mathers AJ. Spread from the sink to the patient: In situ study using green fluorescent protein (GFP) expressing *Escherichia coli* to model bacterial dispersion from hand washing sink-trap reservoirs. *Appl Environ Microbiol*. 2017.
59. Kampf G, Ostermeyer C. Efficacy of alcohol-based gels compared with simple hand wash and hygienic hand disinfection. *J Hosp Infect*. 2004;56 Suppl 2:S13-5.
60. Landers T, Abusalem S, Coty MB, Bingham J. Patient-centered hand hygiene: the next step in infection prevention. *Am J Infect Control*. 2012;40(4 Suppl 1):S11-7.
61. Fasugba O, Cheng AC, Gregory V, Graves N, Koerner J, Collignon P, Gardner A, Mitchell BG. Chlorhexidine for meal cleaning in reducing catheter associated urinary tract infections: a multicentre stepped-wedge randomised controlled trial. *Lancet Infect Dis*. 2019 Jun; 19(6):611-619.
62. Mitchell, B. G., O. Fasugba, A. C. Cheng, V. Gregory, J. Koerner, P. Collignon, A. Gardner, and N. Graves. "Chlorhexidine Versus Saline in Reducing the Risk of Catheter Associated Urinary Tract Infection: A Cost Effectiveness Analysis." *Int J Nurs Stud* 97 (Apr 13 2019): 1-6.
63. H.P. Loveday, J.A. Wilson, R.J. Pratt, M. Golsorkhi, A. Tingle, A. Bak, J. Browne, J. Prieto, M. Wilcox. Epic 3: National Evidence-Based Guidelines for Preventing Healthcare-Associated Infections in NHS Hospitals in England. *Journal of Hospital Infection* 86S1. 2014; S1-S70.
64. Marchaim D, Taylor AR, Hayakawa K, Bheemreddy S, Sunkara B, Moshos J, et al. Hospital bath basins are frequently contaminated with multidrug-resistant human pathogens. *Am J Infect Control*. 2012;40(6):562-4.
65. Johnson D, Lineweaver L, Maze LM. Patients' bath basins as potential sources of infection: a multicenter sampling study. *Am J Crit Care*. 2009;18(1):31-8, 41; discussion 39-40.
66. Gray M, Bliss DZ, Doughty DB, Ermer-Seltun J, Kennedy-Evans KL, Palmer MH. Incontinence-associated Dermatitis: A Consensus. *Journal of Wound Ostomy & Continence Nursing*. 2007;34(1):45-54.
67. Langemo D, Hanson D, Hunter S, Thompson P, Oh IE. Incontinence and incontinence-associated dermatitis. *Adv Skin Wound Care*. 2011;24(3):126-40.
68. Driver DS. Perineal dermatitis in critical care patients. *Crit Care Nurse*. 2007;27(4): 42-6.
69. Bliss DZ, Savik K, Thorson MAL et al. Incontinence associated dermatitis in critically ill adults: tie to development, severity and risk factors. *J Wound Ostomy Continence Nurs*. 2011;38(4): 433-45.
70. Posnett J, Franks PJ. The burden of chronic wounds in the UK. *Nursing Times*; 104; 3, 44-45.
71. Beeckman et al. Incontinence-associated dermatitis: step-by-step prevention and treatment. *Br J Community Nurs*. 2011;16(8):382-9.
72. Black et al. MASD part 2: incontinence-associated dermatitis and intertriginous dermatitis: a consensus. *J Wound Ostomy Continence Nurs*. 2011 Jul-Aug;38(4):359-70; quiz 371-2. doi: 10.1097/WON.0b013e31822272d9.
73. Gray M. Optimal management of incontinence-associated dermatitis in the elderly. *Am J Clin Dermatol*. 2010;11(3):201-10.
74. Schmitz T. Promoting adherence to structured skin care regimen: OI project. *Nurs Manage*. 2012;4(12):44-9.
75. Beeckman D, Verhaeghe S, Defloor T, Schoonhoven L, Vanderwee K. A 3-in-1 perineal care washcloth impregnated with dimethicone 3% versus water and pH neutral soap to prevent and treat incontinence-associated dermatitis: a randomized, controlled clinical trial. *J Wound Ostomy Continence Nurs*. 2011;38(6):627-34.
76. Mitchell BG, Williams A, Wong BN. Assessing the functionality of temporary isolation rooms. *Am J Infect Control*. 45(11):1231-7.
77. NHMRC. Australian Guidelines for the Prevention and Control of Infection in Healthcare. In: Commonwealth of Australia, editor. 2010.
78. Mitchell BG, Williams A, Wong Z, O'Connor J. Assessing a temporary isolation room from an infection control perspective: A discussion paper. *Infection, Disease & Health*. 2017;22(3):129-35.
79. Bures S, Fishbain JT, Uyehara CF, Parker JM, Berg BW. Computer keyboards and faucet handles as reservoirs of nosocomial pathogens in the intensive care unit. *Am J Infect Control*. 2000;28(6):465-71.
80. Rutala WA, White MS, Gergen MF, Weber DJ. Bacterial contamination of keyboards: efficacy and functional impact of disinfectants. *Infect Control Hosp Epidemiol*. 2008;27(4):372-7.
81. Neely AN. A survey of gram-negative bacteria survival on hospital fabrics and plastics. *Journal of Burn Care & Research*. 2000;21(6):523&hyphen.
82. Schultz M, Gill J, Zubairi S, Huber R, Gordin F. Bacterial contamination of computer keyboards in a teaching hospital. *Infect Control Hosp Epidemiol*. 2003;24(4):302-3.
83. Devine J, Cooke R, Wright E. Is methicillin-resistant *Staphylococcus aureus* (MRSA) contamination of ward-based computer terminals a surrogate marker for nosocomial MRSA transmission and handwashing compliance? *Journal of Hospital Infection*. 2001;48(1):72-5.
84. Department of Health. High Impact Intervention No 8: Care bundle to improve the cleaning and decontamination of clinical equipment 2010. Available from: [http://webarchive.nationalarchives.gov.uk/20101125133833/http://www.clean-safe-care.nhs.uk/Documents/High\\_Impact\\_Intervention\\_No\\_8.pdf](http://webarchive.nationalarchives.gov.uk/20101125133833/http://www.clean-safe-care.nhs.uk/Documents/High_Impact_Intervention_No_8.pdf).
85. Rutala, Gergen, Sickbert-Bennett, Huslage, Weber. Comparison of Four Methods to Assess Cleanliness. APIC Presentation [June 2013]. Available from: <http://infectionandsterilization.org/files/2012/12/NewTechAPIC13.ppt>
86. Carling PC, Parry MF, Bruno-Murtha LA, Dick B. Improving environmental hygiene in 27 intensive care units to decrease multidrug resistant bacterial transmission. *Crit Care Med*. 2010 Apr;38(4):1054-9.
87. Grohmann, A., S. Kauffeld S. (2013). Evaluating training programs: development and correlates of the Questionnaire for Professional Training Evaluation. *International Journal of Training and Development* 17(2): 135-155.

International

JBN190812

**GAMA Healthcare Ltd.,**

2 Regal Way, Watford, Hertfordshire, WD24 4YJ, UK.

T: +44 (0)20 7993 0030 E: [info@gamahealthcare.com](mailto:info@gamahealthcare.com) [www.gamahealthcare.com](http://www.gamahealthcare.com)

**gama**  
healthcare